



**FITTING INSTRUCTIONS FOR SS0056 SWINGARM PROTECTORS
TO FIT ZERO FX & DSR 2019-**



Picture A



Picture B

This Kit contains the items pictured and labelled over page.

Some parts may be shown for clarity of instructions only.

Do not proceed until you are sure all parts are present.

Please read all instructions before proceeding.

**IF IN ANY DOUBT WHEN FITTING OUR PRODUCTS, CONSULT ONE OF OUR DEALERS
OR HAVE FITTED BY A QUALIFIED TECHNICIAN.**

Please note that the way the kit is packed does not necessarily represent the way of mounting to the bike.

In the event of rubber washers being used to hold components onto bolts, these rubber washers can be thrown away.

DIGITAL COPIES OF THESE INSTRUCTIONS ARE AVAILABLE FROM

www.rg-racing.com

R&G

Unit 1, Shelley's Lane, East Worldham, Alton, Hampshire, GU34 3AQ

Tel: +44 (0)1420 89007 Fax: +44 (0)1420 87301 www.rg-racing.com Email: info@rg-racing.com



<u>TOOLS REQUIRED</u>	<u>GENERAL TORQUE SETTINGS</u>
<ul style="list-style-type: none"> • Socket Set to Include 2 x 10mm sockets and wrenches. 	<p>M4 BOLT = 8Nm M5 BOLT = 12Nm M6 BOLT = 15Nm M8 BOLT = 20Nm M10 BOLT = 40Nm M12 BOLT = 40Nm</p>

LEGEND

ITEM No.	DESCRIPTION	QTY
ITEM 1	COTTON REELS (B0444 WITH CS324—8mm FITTED) (BOTH SIDES)	2
ITEM 2	S1262 LEFT-HAND-SIDE COTTON REEL SPACER	1
ITEM 3	SB142 SPINDLE BAR (M6 x 347mm LONG)	1
ITEM 4	S1261 RIGHT-HAND-SIDE COTTON REEL SPACER	1
ITEM 5	M6 NYLOC NUT	2
ITEM 6	M6 WASHER (13mm O/D)	2

ASSEMBLY DIAGRAM

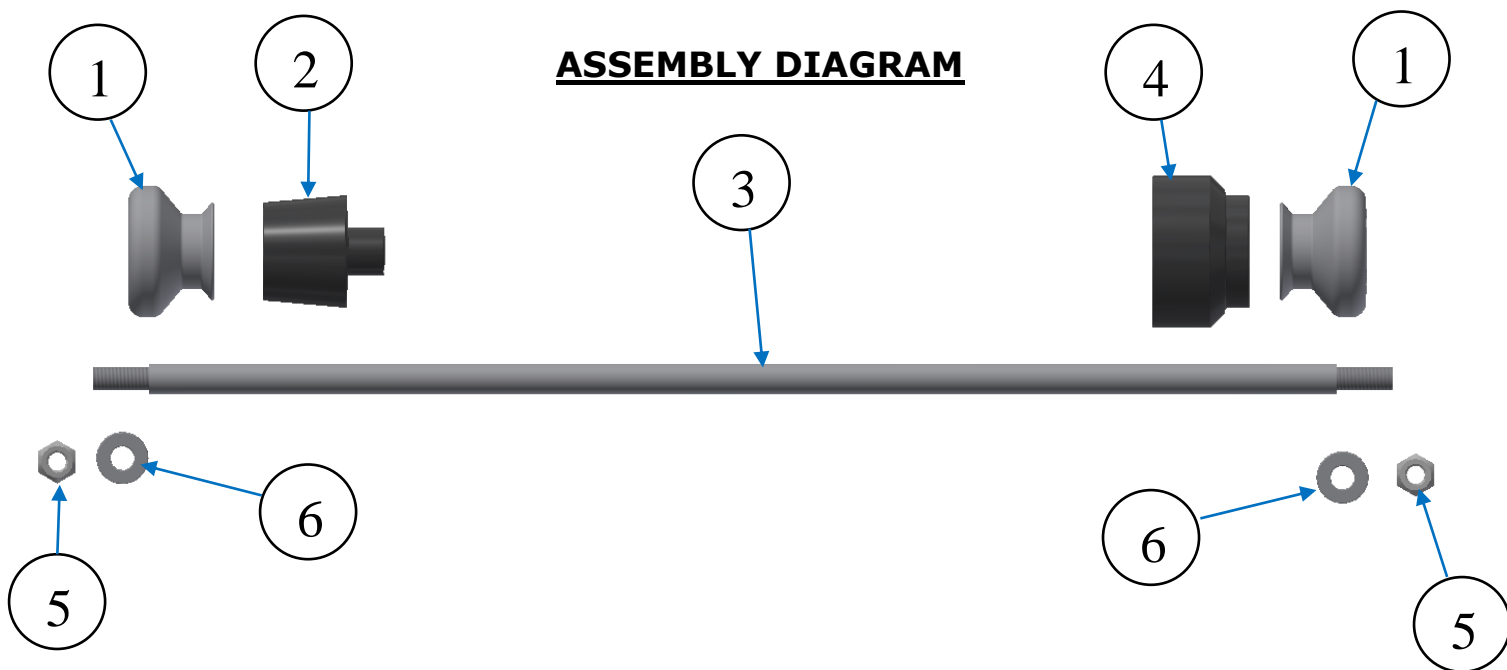

R&G

Unit 1, Shelley's Lane, East Worldham, Alton, Hampshire, GU34 3AQ

Tel: +44 (0)1420 89007 Fax: +44 (0)1420 87301 www.rg-racing.com Email: info@rg-racing.com



FITTING INSTRUCTIONS

- Fit one M6 nut (**item 5**) and one M6 washer (**item 6**) onto one end of the spindle bar (**item 3**) engaging the nut so the plastic insert of the nut is fully engaged and the bar protrudes by 1 or 2 threads. It is recommended to use a small amount of superglue or Loctite to fix this nut as this will aid when tightening the opposite side later.
- Feed the spindle bar with nut and washer through either cotton reel (**item 1**) and then through the spacer with the location diameter (**item 2**) as shown in the **assembly diagram**, then slide this assembly into the left hand side of the rear wheel spindle ensuring the spacer is located into the spindle.
- Moving to the right-hand side of the bike, slide the remaining spacer with the larger location bore (**item 4**) over the exposed end of the spindle bar and over the original spindle nut.
- Fit the remaining cotton reel (**item 1**) over the spindle bar and up to the spacer, then fit the M6 washer (**item 6**) and M6 nut (**item 5**) from the kit onto the thread protruding from the crash protector.
- Finally tighten the nut on both sides evenly using two 10mm sockets and ensure that the plastic insert of both nuts are fully engaged and the protruding threads are equal on both sides. Check the swingarm protectors are secure and held firmly against the spacers and do not spin.
- Do not overtighten – the Nyloc nuts will hold it tight.

ISSUE 1 - 24/04/2020 (NSY)

CONSUMER NOTICE

The catalogue description and any exhibition of samples are only broad indications of the Products and R&G may make design changes which do not diminish their performance or visual appeal and supplying them in such state shall conform to the order. The Buyer acknowledges no representation or warranty (other than as to title) has been given or will apply to the Products other than those in R&G's order or confirmation and the Buyer confirms it has chosen the Products as being of merchantable quality and suitable for its particular purposes. Where R&G fits the Products or undertakes other services it shall exercise reasonable skill and care and rectify any fault free of charge unless the workmanship has been disturbed. The Buyer is responsible for ensuring that the warranty on the motorcycle is not affected by the fitting of the Products. On return of any defective Products R&G shall at its option either supply a replacement or refund the purchase money but shall not be liable if the Products have been modified or used or maintained otherwise than in accordance with R&G's or manufacturer's instructions and good engineering practice or if the defect arises from accident or neglect. Other than identified above and subject to R&G not limiting its liability for causing death and personal injury, it shall not be liable for indirect or consequential loss and otherwise its liability shall be limited to the amounts paid by the Buyer for the Products or the fitting or service concerned. These terms do not affect the Buyer's statutory rights.

R&G RACING RETURNS POLICY (NON-FAULTY GOODS)

Returns must be pre-authorized (if not pre-authorized the return will be rejected). Goods may only be returned direct to us if they were purchased direct from us (customer must prove if necessary). Otherwise to be returned to original vendor. Goods must be in re-sellable condition, in the opinion of R&G Racing. All returns are subject to a 25% restocking and handling fee (25% of the gross value exc. P&P – at the prevailing price at time of purchase). The customer must pay any and all carriage charges. No returns of discontinued products, unless within 14 days of purchase. This policy does not affect your statutory rights and does not refer to faulty goods.

R&G

Unit 1, Shelley's Lane, East Worldham, Alton, Hampshire, GU34 3AQ

Tel: +44 (0)1420 89007 Fax: +44 (0)1420 87301 www.rg-racing.com Email: info@rg-racing.com



**NOTICE DE MONTAGE POUR SS0056 PROTECTIONS BRAS OSCILLANT
POUR ZERO FX & DSR 2019-**



Photo A



Photo B

CE KIT CONTIENT LES ARTICLES ILLUSTRÉS ET ÉTIQUETES SUR LA PAGE.

CERTAINES PARTIES PEUVENT ÊTRE PRÉSENTES UNIQUEMENT POUR LA CLARTÉ DES INSTRUCTIONS.

NE PAS PROCÉDER AU MONTAGE TANT QUE VOUS N'ÊTES PAS SÛR QUE TOUTES LES PIÈCES SOIENT PRÉSENTES.

VEUILLEZ LIRE TOUTES LES INSTRUCTIONS AVANT DE CONTINUER.

EN CAS DE DOUTE LORS DU MONTAGE DE NOS PRODUITS, CONSULTEZ UN DE NOS REVENDUEURS OU FAITES APPEL À UN TECHNICIEN QUALIFIÉ.

VEUILLEZ NOTER QUE LA FAÇON DONT LE KIT EST EMBALLÉ NE REPRÉSENTE PAS NECESSAIREMENT LA MANIÈRE DE LE MONTER SUR LA MOTO.

SI DES RONDELLES EN CAOUTCHOUC SONT UTILISÉES POUR MAINTENIR LES COMPOSANTS SUR LES BOULONS, ELLES PEUVENT ÊTRE JETÉES.

NOTICE DISPONIBLE AU TÉLÉCHARGEMENT SUR :

WWW.RG-RACING.COM

R&G

Unit 1, Shelley's Lane, East Worldham, Alton, Hampshire, GU34 3AQ

Tel: +44 (0)1420 89007 Fax: +44 (0)1420 87301 www.rg-racing.com Email: info@rg-racing.com

**OUTILS REQUIS**

- Clés à cliquet + douilles 2 x 10mm.

VALEURS DE SERRAGE

M4 BOULON = 8Nm
 M5 BOULON = 12Nm
 M6 BOULON = 15Nm
 M8 BOULON = 20Nm
 M10 BOULON = 40Nm
 M12 BOULON = 40Nm

LÉGÈNDE

ARTICLE No.	DESCRIPTION	QTÉ
ARTICLE 1	BOBINES DE PROTECTION (B0444 WITH CS324—8mm MONTÉES) (DES 2 CÔTÉS)	2
ARTICLE 2	S1262 ENTRETOISE DE PROTECTION CÔTÉ GAUCHE	1
ARTICLE 3	SB142 AXE (M6 x 347mm DE LONG)	1
ARTICLE 4	S1261 ENTRETOISE DE PROTECTION CÔTÉ DROIT	1
ARTICLE 5	M6 ÉCROU	2
ARTICLE 6	M6 RONDELLE (13mm O/D)	2

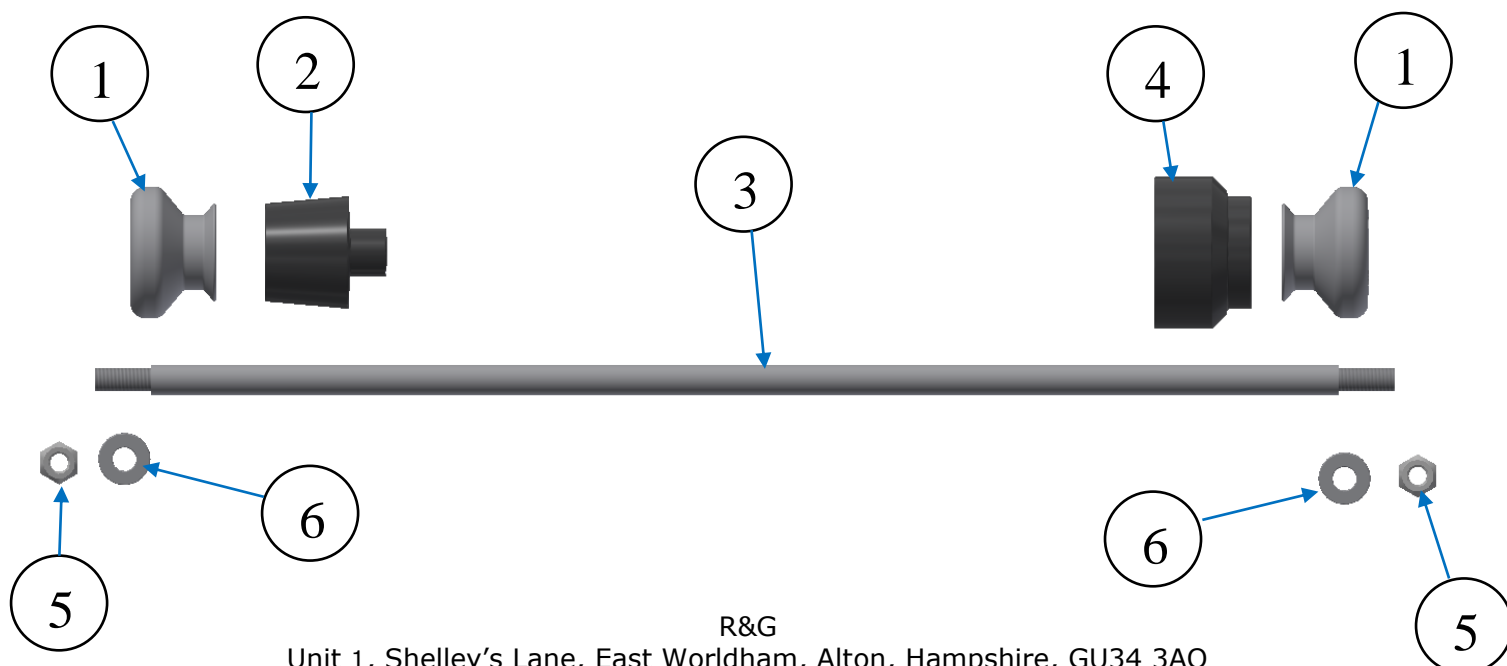
SCHÈMA D'ASSEMBLAGE

R&G

Unit 1, Shelley's Lane, East Worldham, Alton, Hampshire, GU34 3AQ

Tel: +44 (0)1420 89007 Fax: +44 (0)1420 87301 www.rg-racing.com Email: info@rg-racing.com



NOTICE DE MONTAGE

- Montez un écrou M6 (article 5) et une rondelle M6 (article 6) sur une extrémité de l'axe (article 3) en engageant l'écrou de sorte que l'insert en plastique de l'écrou soit complètement engagé et que l'axe dépasse de 1 ou 2 filets. Il est recommandé d'utiliser une petite quantité de superglue ou de Loctite pour fixer cet écrou, car cela facilitera le serrage du côté opposé plus tard.
- Faites passer l'axe avec l'écrou et la rondelle à travers l'une des bobines de protection (article 1), puis à travers l'entretoise avec le plus petit diamètre d'emplacement (article 2) comme indiqué sur le schéma d'assemblage, puis faites glisser cet assemblage du côté gauche de l'axe de roue arrière en veillant à ce que l'entretoise se trouve dans l'axe.
- En vous déplaçant du côté droit de la moto, faites glisser l'entretoise restante avec le fraisage d'emplacement plus grand (article 4) sur l'extrémité exposée de l'axe et sur l'écrou de l'axe d'origine.
- Placez la bobine de protection restante (article 1) sur l'axe et l'entretoise, puis placez la rondelle M6 (article 6) et l'écrou M6 (article 5) du kit sur le filetage qui dépasse de la protection crash.
- Enfin, serrez uniformément l'écrou des deux côtés à l'aide de deux douilles de 10 mm et assurez-vous que l'insert en plastique des deux écrous soit complètement engagé et que les filetages qui dépassent soient égaux des deux côtés. Vérifiez que les protections du bras oscillant soient bien fixées et maintenues fermement contre les entretoises et ne tournent pas.
- Ne serrez pas trop - les écrous fixent l'ensemble.

ISSUE 1 - 24/04/2020 (NSY)

R&G

Unit 1, Shelley's Lane, East Worldham, Alton, Hampshire, GU34 3AQ

Tel: +44 (0)1420 89007 Fax: +44 (0)1420 87301 www.rg-racing.com Email: info@rg-racing.com