



FITTING INSTRUCTIONS FOR SP0108 SWINGARM PROTECTORS



THIS KIT CONTAINS THE ITEMS PICTURED AND LABELLED OVER PAGE.

SOME PARTS MAY BE SHOWN FOR CLARITY OF INSTRUCTIONS ONLY.

DO NOT PROCEED UNTIL YOU ARE SURE ALL PARTS ARE PRESENT.

PLEASE READ ALL INSTRUCTIONS BEFORE PROCEEDING.

IF IN ANY DOUBT WHEN FITTING OUR PRODUCTS, CONSULT ONE OF OUR DEALERS OR HAVE FITTED BY A QUALIFIED TECHNICIAN.

PLEASE NOTE THAT THE WAY THE KIT IS PACKED DOES NOT NECESSARILY REPRESENT THE WAY OF MOUNTING TO THE BIKE.

IN THE EVENT OF RUBBER WASHERS BEING USED TO HOLD COMPONENTS ONTO BOLTS,
THESE RUBBER WASHERS CAN BE THROWN AWAY.

DIGITAL COPIES OF THESE INSTRUCTIONS ARE AVAILABLE FROM:

WWW.RG-RACING.COM

R&G Racing
Unit 1, Shelley's Lane, East Worldham, Alton, Hampshire, GU34 3AQ
Tel: +44 (0)1420 89007 www.rg-racing.com Email: info@rg-racing.com



<u>TOOLS REQUIRED</u>	<u>GENERAL TORQUE SETTINGS</u>
4mm Allen Key	M4 BOLT = 8Nm M5 BOLT = 12Nm M6 BOLT = 15Nm M8 BOLT = 20Nm M10 BOLT = 40Nm M12 BOLT = 40Nm

ONLY TO BE USED ON MACHINES FITTED WITH SPINDLE MEASURING 16mm AND 23.5mm LOCATION DIAMETERS

LEGEND

ITEM NO.	DESCRIPTION	QTY
ITEM 1	LHS MOUNTING BLOCK (M0354)	1
ITEM 2	LHS BOBBIN (B0481)	1
ITEM 3	M6 x 40mm BOLT (LHS)	1
ITEM 4	RHS MOUNTING BLOCK (M0818)	1
ITEM 5	RHS BOBBIN (B0580)	1
ITEM 6	M6 x 55mm BOLT (RHS)	1
ITEM 7	M6 EXPANDER NUT	2

ASSEMBLY DIAGRAM

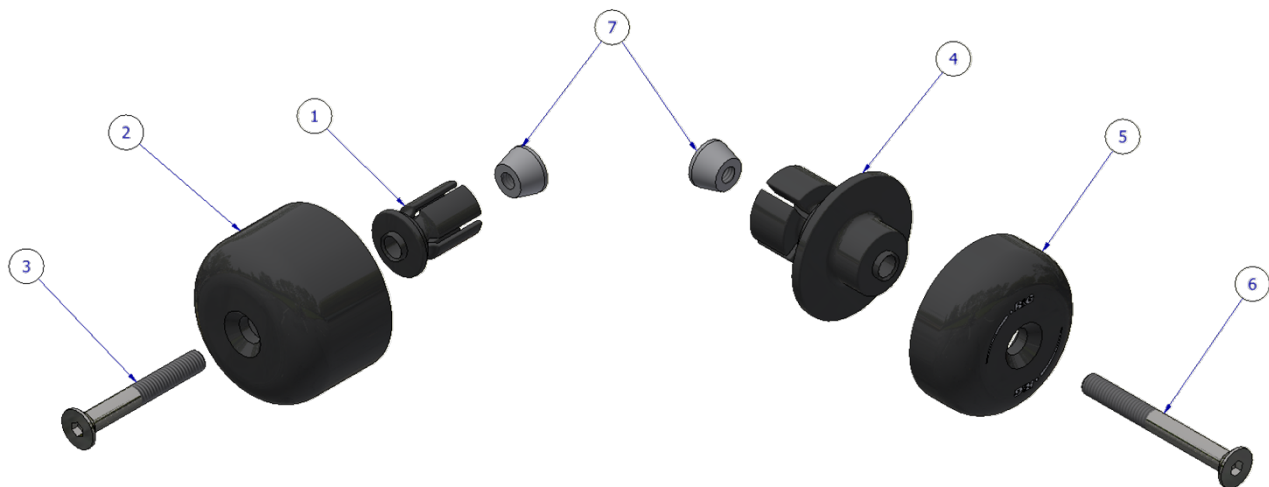



FITTING INSTRUCTIONS

LHS (as you sit on bike)

- Fit the shorter counter sunk bolt (**item 3**) through the larger bobbin (**item 2**) so head sits in the counter-sink.
- Place the larger bobbin (**item 2**) on to the smaller mounting block (**item 1**).
- Place special nut (**item 7**) on exposed end of bolt so tapered face goes into recess of the mounting block.
- Tighten bolt until tapered portion of nut just contacts in the recessed face of the mounting block.
- Place this assembly into the left-hand side of the rear wheel spindle.
- Tighten the bolt so crash protector is held in position firmly (do not over tighten).
- **Regularly check to ensure crash protector remains tight.**

RHS (as you sit on bike)

- Fit the longer counter sunk bolt (**item 6**) through the smaller bobbin (**item 5**) so head sits in the counter-sink.
- Place the smaller bobbin (**item 5**) on to the larger mounting block (**item 4**).
- Place special nut (**item 7**) on exposed end of bolt so tapered face goes into recess of the mounting block.
- Tighten bolt until tapered portion of nut just contacts in the recessed face of the mounting block.
- Place this assembly into the right-hand side of the rear wheel spindle.
- Tighten the bolt so crash protector is held in position firmly (do not over tighten).
- **Regularly check to ensure crash protector remains tight.**

ISSUE 1 – 19/09/2024 (MH)

CONSUMER NOTICE

The catalogue description and any exhibition of samples are only broad indications of the Products and R&G may make design changes which do not diminish their performance or visual appeal and supplying them in such state shall conform to the order. The Buyer acknowledges no representation or warranty (other than as to title) has been given or will apply to the Products other than those in R&G's order or confirmation and the Buyer confirms it has chosen the Products as being of merchantable quality and suitable for its particular purposes. Where R&G fits the Products or undertakes other services it shall exercise reasonable skill and care and rectify any fault free of charge unless the workmanship has been disturbed. The Buyer is responsible for ensuring that the warranty on the motorcycle is not affected by the fitting of the Products. On return of any defective Products R&G shall at its option either supply a replacement or refund the purchase money but shall not be liable if the Products have been modified or used or maintained otherwise than in accordance with R&G's or manufacturer's instructions and good engineering practice or if the defect arises from accident or neglect. Other than identified above and subject to R&G not limiting its liability for causing death and personal injury, it shall not be liable for indirect or consequential loss and otherwise its liability shall be limited to the amounts paid by the Buyer for the Products or the fitting or service concerned. These terms do not affect the Buyer's statutory rights.

R&G RACING RETURNS POLICY (NON-FAULTY GOODS)

Returns must be pre-authorized (if not pre-authorized the return will be rejected). Goods may only be returned direct to us if they were purchased direct from us (customer must prove if necessary). Otherwise to be returned to original vendor. Goods must be in re-sellable condition, in the opinion of R&G Racing. All returns are subject to a 25% restocking and handling fee (25% of the gross value exc. P&P – at the prevailing price at time of purchase). The customer must pay any and all carriage charges. No returns of discontinued products, unless within 14 days of purchase. This policy does not affect your statutory rights and does not refer to faulty goods.

R&G Racing
Unit 1, Shelley's Lane, East Worldham, Alton, Hampshire, GU34 3AQ
Tel: +44 (0)1420 89007 www.rg-racing.com Email: info@rg-racing.com



NOTICE DE MONTAGE POUR SP0108 PROTECTIONS BRAS OSCILLANT



CE KIT CONTIENT LES ARTICLES ILLUSTRES ET ETIQUETES SUR LA PAGE.

CERTAINES PARTIES PEUVENT ETRE PRESENTES UNIQUEMENT POUR LA CLARTE DES INSTRUCTIONS.

NE PAS PROCEDER AU MONTAGE TANT QUE VOUS N'ETES PAS SUR QUE TOUTES LES PIECES SOIENT PRESENTES.

VEUILLEZ LIRE TOUTES LES INSTRUCTIONS AVANT DE CONTINUER.

EN CAS DE DOUTE LORS DU MONTAGE DE NOS PRODUITS, CONSULTEZ UN DE NOS REVENDEURS OU FAITES APPEL A UN TECHNICIEN QUALIFIE.

VEUILLEZ NOTER QUE LA FAÇON DONT LE KIT EST EMBALLE NE REPRESENTE PAS NECESSAIREMENT LA MANIERE DE LE MONTER SUR LA MOTO.

SI DES RONDELLES EN CAOUTCHOUC SONT UTILISEES POUR MAINTENIR LES COMPOSANTS SUR LES BOULONS, ELLES PEUVENT ETRE JETEES.

NOTICE DISPONIBLE AU TELECHARGEMENT SUR :

WWW.RG-RACING.COM



<u>OUTILS REQUIS</u>	<u>VALEURS DE SERRAGE</u>
Clé Allen 4mm	M4 BOULON = 8Nm
	M5 BOULON = 12Nm
	M6 BOULON = 15Nm
	M8 BOULON = 20Nm
	M10 BOULON = 40Nm
	M12 BOULON = 40Nm

À UTILISER UNIQUEMENT SUR DES MACHINES ÉQUIPÉES D'AXE MESURANT DES DIAMÈTRES D'EMPLACEMENT DE 16 MM ET 23,5 MM

LÉGENDE

ARTICLE NO.	DESCRIPTION	QTÉ
ARTICLE 1	BLOC DE MONTAGE GAUCHE (M0354)	1
ARTICLE 2	PROTECTION CRASH GAUCHE (B0481)	1
ARTICLE 3	M6 x 40mm BOULON (GAUCHE)	1
ARTICLE 4	BLOC DE MONTAGE CÔTÉ DROIT (M0818)	1
ARTICLE 5	PROTECTION CÔTÉ DROIT (B0580)	1
ARTICLE 6	M6 x 55mm BOULON (CÔTÉ DROIT)	1
ARTICLE 7	M6 ÉCROU D'EXPANSION	2

SCHÉMA D'ENSEMBLE

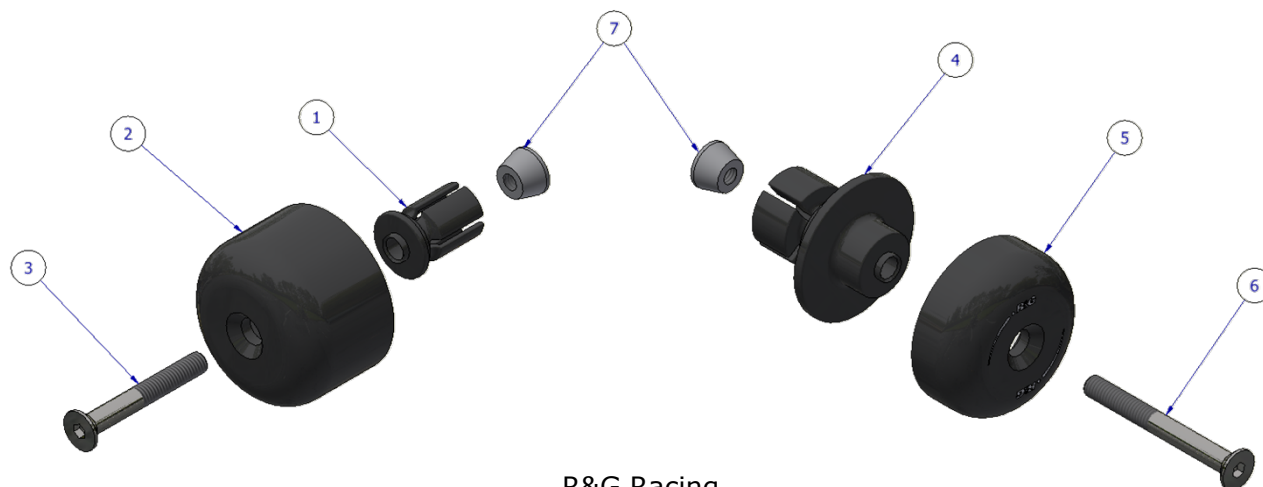



NOTICE DE MONTAGE

Côté gauche (Lorsqu'on est assis sur la moto)

- Insérez le boulon à tête fraisée le plus court (article 3) dans la protection la plus grande (article 2) de manière à ce que la tête repose dans la fraisure.
- Placez la protection la plus grande (article 2) sur le bloc de montage le plus petit (article 1).
- Placez l'écrou spécial (article 7) sur l'extrémité exposée du boulon de manière à ce que la face conique s'insère dans le creux du bloc de montage.
- Serrez le boulon jusqu'à ce que la partie conique de l'écrou entre en contact avec la face encastrée du bloc de montage.
- Placez cet ensemble du côté gauche de l'axe de roue arrière.
- Serrez le boulon de manière à ce que la protection crash soit fermement maintenue en position (ne serrez pas trop).
- Vérifiez régulièrement que la protection crash reste bien serrée.

Côté droit (Lorsqu'on est assis sur la moto)

- Insérez le boulon à tête fraisée le plus long (article 6) dans la plus petite protection (article 5) de manière à ce que la tête repose dans la fraisure.
- Placez la plus petite protection (article 5) sur le plus grand bloc de montage (article 4).
- Placez l'écrou spécial (article 7) sur l'extrémité exposée du boulon de manière à ce que la face conique s'insère dans le creux du bloc de montage.
- Serrez le boulon jusqu'à ce que la partie conique de l'écrou entre en contact avec la face encastrée du bloc de montage.
- Placez cet ensemble du côté droit de l'axe de roue arrière.
- Serrez le boulon de manière à ce que la protection crash soit fermement maintenue en position (ne serrez pas trop).
- Vérifiez régulièrement que la protection crash reste bien serrée.

ISSUE 1 – 19/09/2024 (MH)

CONSUMER NOTICE

The catalogue description and any exhibition of samples are only broad indications of the Products and R&G may make design changes which do not diminish their performance or visual appeal and supplying them in such state shall conform to the order. The Buyer acknowledges no representation or warranty (other than as to title) has been given or will apply to the Products other than those in R&G's order or confirmation and the Buyer confirms it has chosen the Products as being of merchantable quality and suitable for its particular purposes. Where R&G fits the Products or undertakes other services it shall exercise reasonable skill and care and rectify any fault free of charge unless the workmanship has been disturbed. The Buyer is responsible for ensuring that the warranty on the motorcycle is not affected by the fitting of the Products. On return of any defective Products R&G shall at its option either supply a replacement or refund the purchase money but shall not be liable if the Products have been modified or used or maintained otherwise than in accordance with R&G's or manufacturer's instructions and good engineering practice or if the defect arises from accident or neglect. Other than identified above and subject to R&G not limiting its liability for causing death and personal injury, it shall not be liable for indirect or consequential loss and otherwise its liability shall be limited to the amounts paid by the Buyer for the Products or the fitting or service concerned. These terms do not affect the Buyer's statutory rights.

R&G RACING RETURNS POLICY (NON-FAULTY GOODS)

Returns must be pre-authorized (if not pre-authorized the return will be rejected). Goods may only be returned direct to us if they were purchased direct from us (customer must prove if necessary). Otherwise to be returned to original vendor. Goods

R&G Racing
Unit 1, Shelley's Lane, East Worldham, Alton, Hampshire, GU34 3AQ
Tel: +44 (0)1420 89007 www.rg-racing.com Email: info@rg-racing.com



must be in re-sellable condition, in the opinion of R&G Racing. All returns are subject to a 25% restocking and handling fee (25% of the gross value exc. P&P – at the prevailing price at time of purchase). The customer must pay any and all carriage charges. No returns of discontinued products, unless within 14 days of purchase. This policy does not affect your statutory rights and does not refer to faulty goods.