



819900 KTM 1290 Superduke R Shock Shield Fitting Instructions

No extra fittings are required to fit the Pyramid Shock Shield.

The Pyramid Shock Shield is easy to fit - simply remove the 2 large bolts holding the pillion footpegs on underneath the seat. Then loosen the other 2 large bolts holding the pillion footpegs at the sides of the bike (there is no need to fully remove these side bolts).

Place the Pyramid Shock Shield behind the two mounting points and refit the original bolts.

sales@pyramid-plastics.co.uk
+44 (0)1427 677990
www.pyramid-plastics.co.uk



Follow us on social media and feel free to leave us a review!

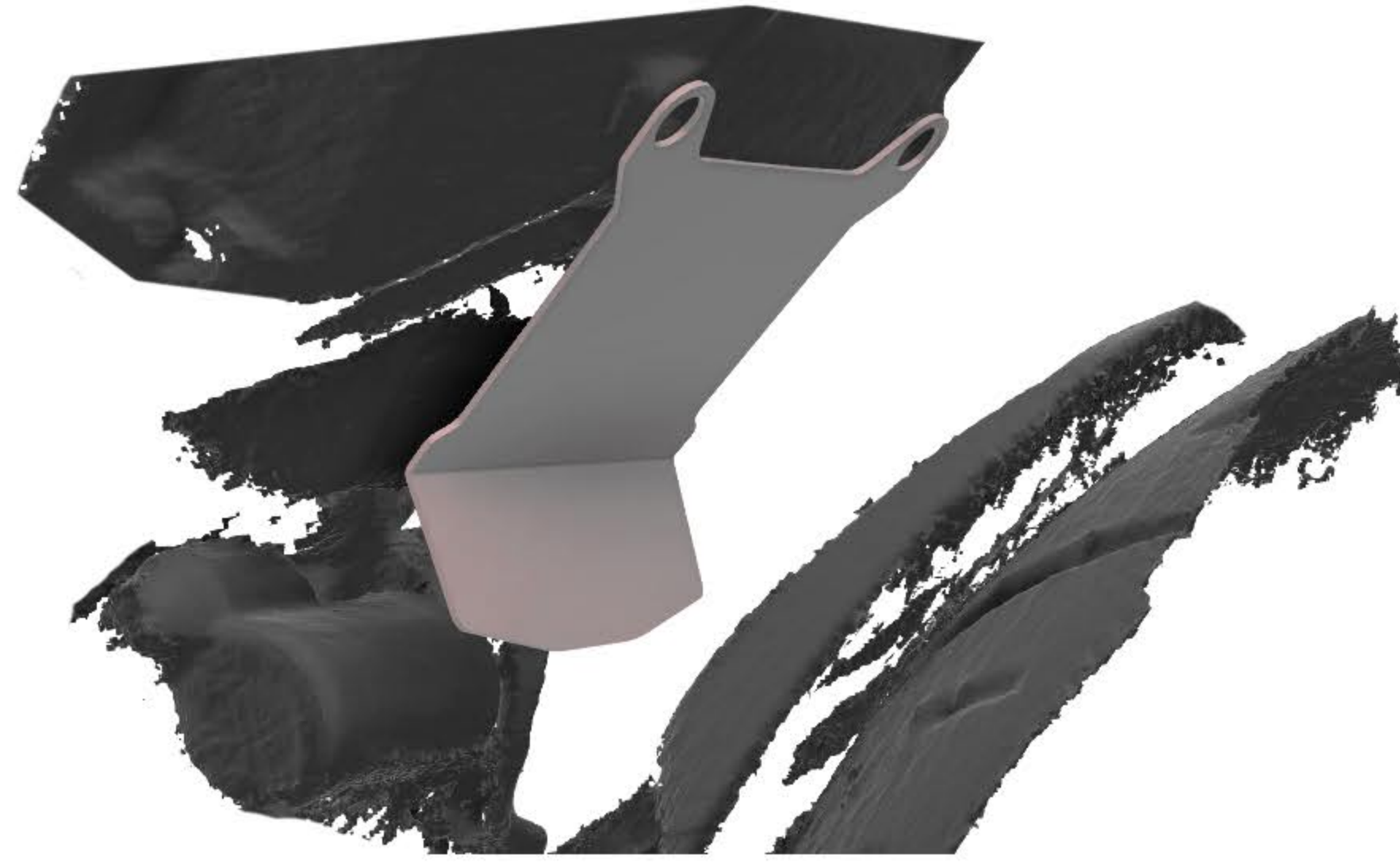

819900 KTM 1290 Superduke R Shock Shield Fitting Instructions

No extra fittings are required to fit the Pyramid Shock Shield.

The Pyramid Shock Shield is easy to fit - simply remove the 2 large bolts holding the pillion footpegs on underneath the seat. Then loosen the other 2 large bolts holding the pillion footpegs at the sides of the bike (there is no need to fully remove these side bolts).

Place the Pyramid Shock Shield behind the two mounting points and refit the original bolts.

sales@pyramid-plastics.co.uk
+44 (0)1427 677990
www.pyramid-plastics.co.uk



Follow us on social media and feel free to leave us a review!

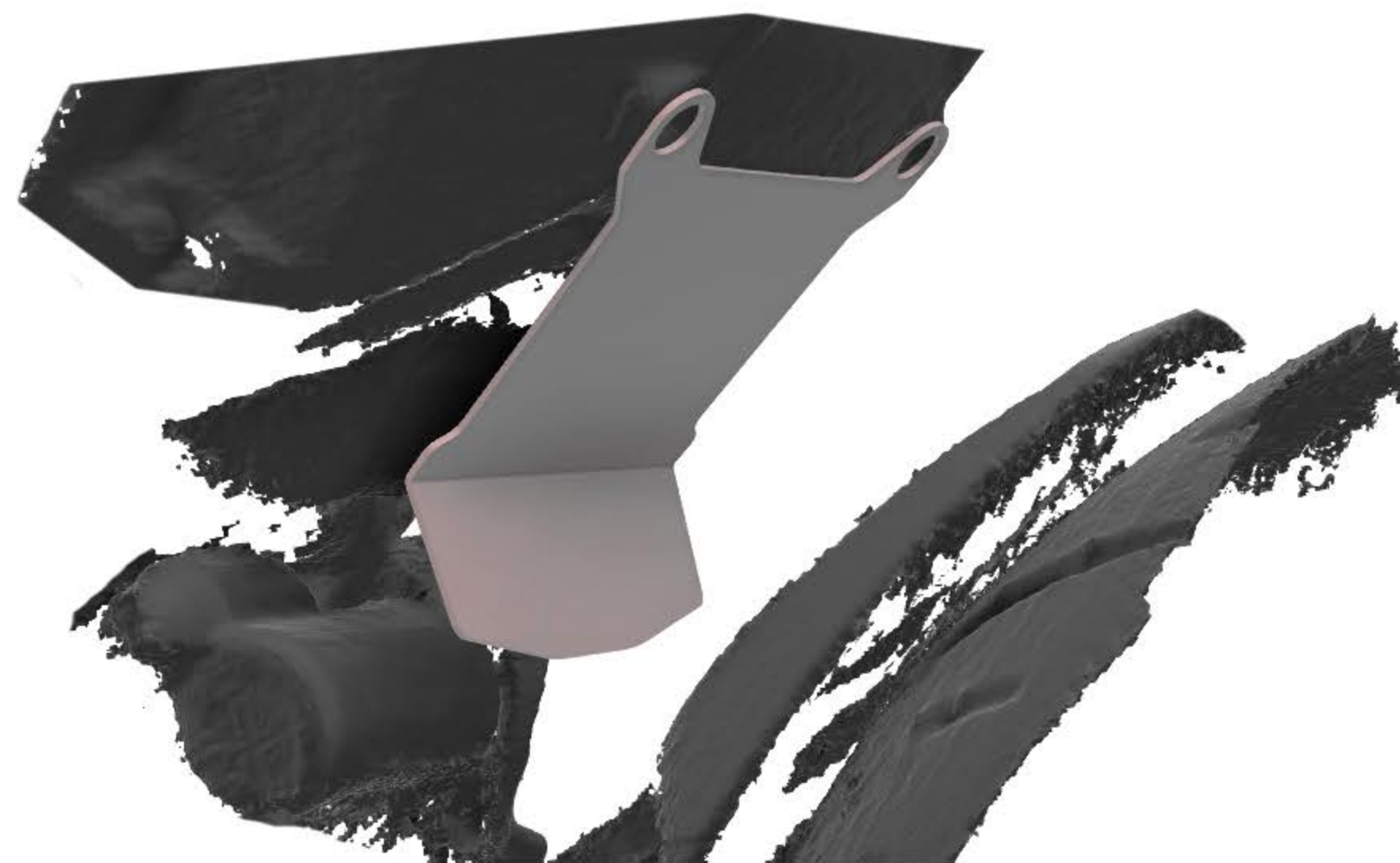

819900 KTM 1290 Superduke R Shock Shield Fitting Instructions

No extra fittings are required to fit the Pyramid Shock Shield.

The Pyramid Shock Shield is easy to fit - simply remove the 2 large bolts holding the pillion footpegs on underneath the seat. Then loosen the other 2 large bolts holding the pillion footpegs at the sides of the bike (there is no need to fully remove these side bolts).

Place the Pyramid Shock Shield behind the two mounting points and refit the original bolts.

sales@pyramid-plastics.co.uk
+44 (0)1427 677990
www.pyramid-plastics.co.uk



Follow us on social media and feel free to leave us a review!

