



FITTING INSTRUCTIONS FOR LP0320 LICENCE PLATE BRACKET
TRIUMPH SPEED TRIPLE 1200 RS 2021-



This kit contains the items pictured and labelled over page.
Some parts may be shown for clarity of instructions only.
Do not proceed until you are sure all parts are present.
Please read all instructions before proceeding.

IF IN ANY DOUBT WHEN FITTING OUR PRODUCTS, CONSULT ONE OF OUR DEALERS
OR HAVE FITTED BY A QUALIFIED TECHNICIAN.

Please note that the way the kit is packed does not necessarily represent the way of mounting to the bike.

In the event of rubber washers being used to hold components onto bolts, these rubber washers can be thrown away.

DIGITAL COPIES OF THESE INSTRUCTIONS ARE AVAILABLE FROM
WWW.RG-RACING.COM



| <u>TOOLS REQUIRED</u> | <u>GENERAL TORQUE SETTINGS</u> |
|---|---|
| <ul style="list-style-type: none"> • Set of Torx keys or bits including T20, T25, T30. • Set of metric Allen keys to include 3, 4, 5 & 6mm <ul style="list-style-type: none"> • 6 & 8mm spanner or socket. • Phillips screwdriver. • Small flat head screwdriver. | M4 BOLT = 8Nm M5 BOLT = 12Nm M6 BOLT = 15Nm M8 BOLT = 20Nm M10 BOLT = 40Nm M12 BOLT = 40Nm |

LEGEND

| ITEM No. | DESCRIPTION | QTY |
|-----------------|---|------------|
| ITEM 1 | TB0320BK PART 1 - MAIN BRACKET RHS | 1 |
| ITEM 2 | TB0320BK PART 2 - MAIN BRACKET LHS | 1 |
| ITEM 3 | TB0320BK PART 3 - LICENSE PLATE BRACKET | 1 |
| ITEM 4 | S1360 - MOUNTING SPACERS | 4 |
| ITEM 5 | CON0065 - LICENCE PLATE ILLUMINATOR CONNECTOR | 1 |
| ITEM 6 | CON0046 - INDICATOR CONNECTOR | 2 |
| ITEM 7 | LA0002 - NUMBER PLATE LIGHT ASSEMBLY | 1 |
| ITEM 8 | M5x0.8x10.0 mm COUNTER SUNK SCREWS | 4 |
| ITEM 9 | M5x0.8 NYLOC NUTS | 4 |
| ITEM 10 | M5x10mm WASHERS | 4 |
| ITEM 11 | REFL 3 - REFLECTOR | 1 |
| ITEM 12 | 150mm LENGTH OF HEATSHRINK | 3 |
| ITEM 13 | 2.5mm CABLE TIES | 6 |
| ITEM 14 | IWC0002 - MINI INDICATOR WIRING COVERS | 2 |
| ITEM 15 | CLIP 1 - SELF ADHEISIVE CABLE CLIPS | 2 |
| ITEM 16 | M6 NYLOC NUTS | 2 |
| ITEM 17 | M6x1.0x15mm BUTTON HEAD SCREWS | 2 |
| ITEM 18 | M6x19mm WASHERS | 6 |

R&G

Unit 1, Shelley's Lane, East Worldham, Alton, Hampshire, GU34 3AQ

Tel: +44 (0)1420 89007 Fax: +44 (0)1420 87301 www.rg-racing.com Email: info@rg-racing.com



ASSEMBLY DIAGRAM

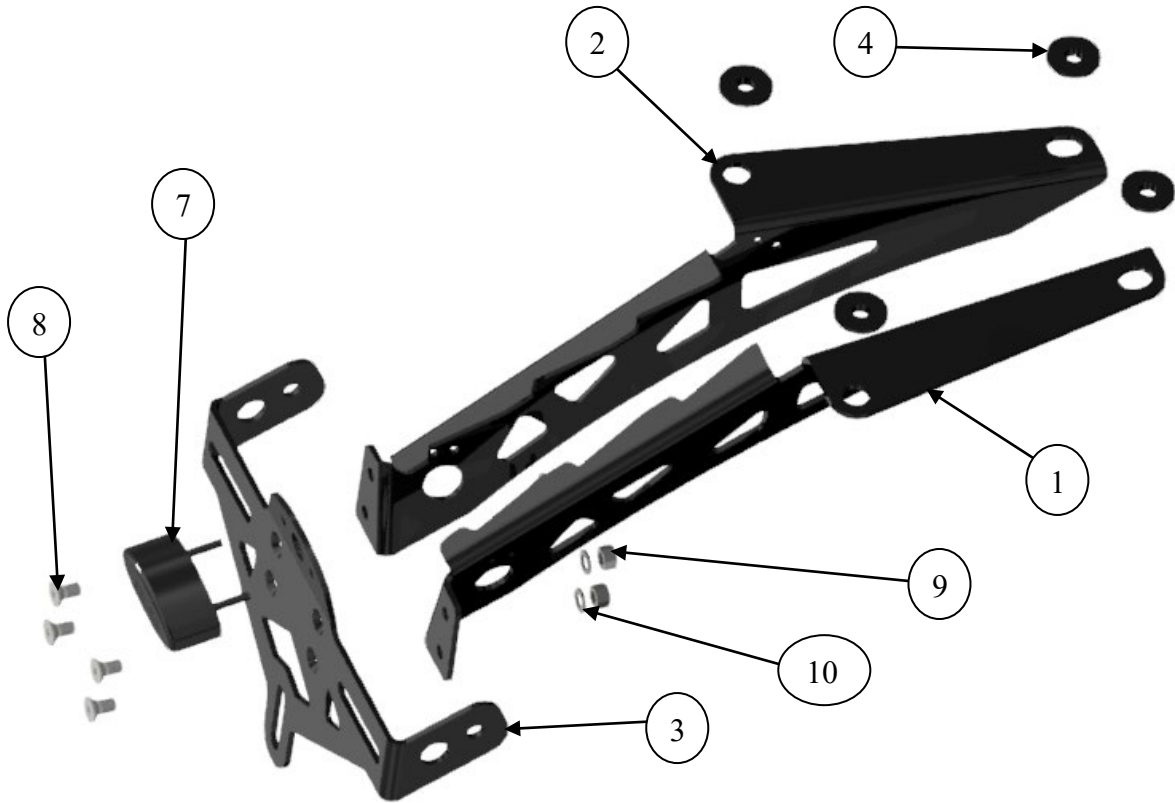

R&G

Unit 1, Shelley's Lane, East Worldham, Alton, Hampshire, GU34 3AQ

Tel: +44 (0)1420 89007 Fax: +44 (0)1420 87301 www.rg-racing.com Email: info@rg-racing.com



FITTING PICTURES



Picture 1



Picture 2



Picture 3



Picture 4



Picture 5

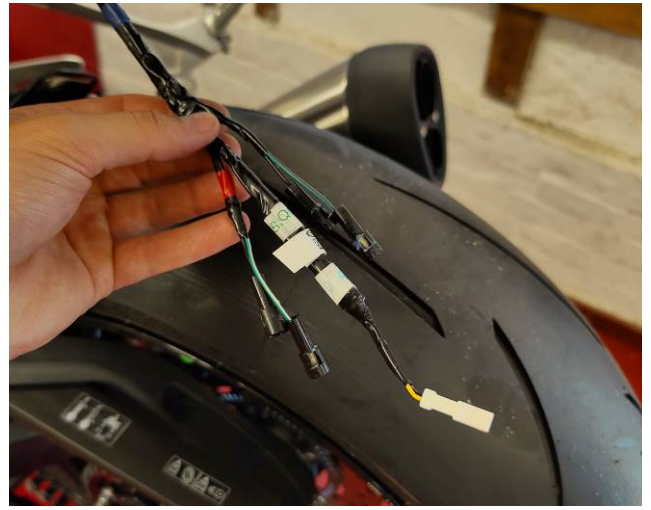

Picture 6



Picture 7



Picture 8



Picture 9



Picture 10

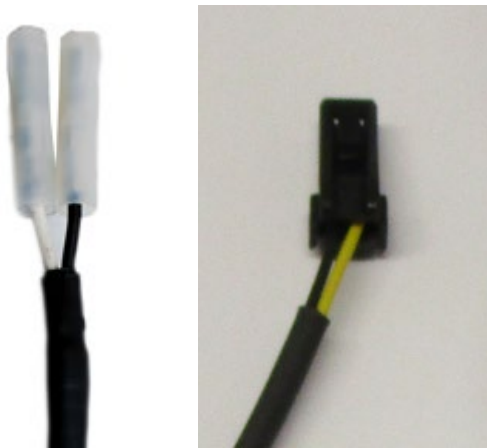

Picture 11



Picture 12



Picture 13



Picture 14

FITTING INSTRUCTIONS

- Begin by unscrewing the bolts securing the OEM license plate holder to the tail unit of the bike with a T20 Torx driver as shown in **Picture 1**.
- This will leave the license plate holder loose and connected only by the indicator wires, keep the license plate holder supported so that the wires are not damaged.
- Gently pull the plastic cover piece to remove it as shown in **Picture 3**.
- This will expose the 2 screws shown in **Picture 4**. These must be removed using a T20 Torx drive to separate the 2 halves of the license plate holder.
- The remaining plastic covers can now be carefully removed.
- With the indicator and illuminator connectors exposed as shown in **Picture 5**, disconnect these, and remove the OEM license plate holder, leaving the wires shown in **Picture 6**. (Take note of which indicators are connected to the left and right sides as these will need to be reconnected correctly when re-connecting the R&G tail tidy.)
- If using the OEM indicators, remove the bolts holding these to the license plate holder and unthread the wires to free them. These can then be secured to the R&G Tail Tidy using the M6 screws and nyloc nuts provided.

R&G

Unit 1, Shelley's Lane, East Worldham, Alton, Hampshire, GU34 3AQ

Tel: +44 (0)1420 89007 Fax: +44 (0)1420 87301 www.rg-racing.com Email: info@rg-racing.com



- Assemble the R&G tail tidy as shown in **Picture 7** and **Picture 8** using the M5 fasteners provided.
- Attach the R&G license plate illuminator (**Item 7**) as shown in **Picture 9**.
- Insert the spacers (**Item 4**) into the mounting holes as shown in **Picture 10** ensuring that the flat sides face upwards.
- Connect CON0065 License plate illuminator connector (**Item 5**) as shown on the RHS of **Picture 11**, to the illuminator wires.
- If using R&G or aftermarket indicators, connect CON0046 Indicator connector (**Item 6**) to the indicator wires as shown in LHS of **Picture 11**.
- Reconnect the indicator and illuminator connectors to the wires protruding from the tail unit of the motorcycle. Ensure that the left and right indicators are connected correctly. (This can be checked by turning on the ignition and testing that they flash correctly.)
- Attach the R&G tail tidy to the tail unit of the motorcycle using the same 4 Torx screws which were removed from the OEM license plate holder as well as the M6 washers provided as shown in **Picture 13**.
- The wires can be tidied up using the cable ties and cable tie slots in the tail tidy as shown in **Picture 14**.

IMPORTANT: IF FITTING A FULL-SIZE LICENCE PLATE AND PLACING IT FAR DOWN ON THE LICENCE PLATE HANGER, THERE IS A SMALL CHANCE OF THE LICENCE PLATE HITTING THE BACK WHEEL UNDER HEAVY LOAD AND OVER LARGE BUMPS IN THE ROAD. IT IS YOUR RESPONSIBILITY TO CHECK FOR THIS POSSIBILITY AND TAKE AVOIDING ACTION. FAILURE TO CHECK THIS COULD RESULT IN SERIOUS INJURY.

ISSUE 1 - 30/07/2021 - (WW)

CONSUMER NOTICE

The catalogue description and any exhibition of samples are only broad indications of the Products and R&G may make design changes which do not diminish their performance or visual appeal and supplying them in such state shall conform to the order. The Buyer acknowledges no representation or warranty (other than as to title) has been given or will apply to the Products other than those in R&G's order or confirmation and the Buyer confirms it has chosen the Products as being of merchantable quality and suitable for its particular purposes. Where R&G fits the Products or undertakes other services it shall exercise reasonable skill and care and rectify any fault free of charge unless the workmanship has been disturbed. The Buyer is responsible for ensuring that the warranty on the motorcycle is not affected by the fitting of the Products. On return of any defective Products R&G shall at its option either supply a replacement or refund the purchase money but shall not be liable if the Products have been modified or used or maintained otherwise than in accordance with R&G's or manufacturer's instructions and good engineering practice or if the defect arises from accident or neglect. Other than identified above and subject to R&G not limiting its liability for causing death and personal injury, it shall not be liable for indirect or consequential loss and otherwise its liability shall be limited to the amounts paid by the Buyer for the Products or the fitting or service concerned. These terms do not affect the Buyer's statutory rights.

R&G RACING RETURNS POLICY (NON-FAULTY GOODS)

Returns must be pre-authorized (if not pre-authorized the return will be rejected). Goods may only be returned direct to us if they were purchased direct from us (customer must prove if necessary). Otherwise to be returned to original vendor. Goods must be in re-sellable condition, in the opinion of R&G Racing. All returns are subject to a 25% restocking and handling fee (25% of the gross value exc. P&P – at the prevailing price at time of purchase). The customer must pay any and all carriage charges. No returns of discontinued products, unless within 14 days of purchase. This policy does not affect your statutory rights and does not refer to faulty goods.

R&G

Unit 1, Shelley's Lane, East Worldham, Alton, Hampshire, GU34 3AQ

Tel: +44 (0)1420 89007 Fax: +44 (0)1420 87301 www.rg-racing.com Email: info@rg-racing.com



NOTICE DE MONTAGE POUR LP0320 SUPPORT DE PLAQUE
TRIUMPH SPEED TRIPLE 1200 RS 2021-



CE KIT CONTIENT LES ARTICLES ILLUSTRÉS ET ÉTIQUETES SUR LA PAGE.

CERTAINES PARTIES PEUVENT ÊTRE PRÉSENTES UNIQUEMENT POUR LA CLARTÉ DES INSTRUCTIONS.

NE PAS PROCÉDER AU MONTAGE TANT QUE VOUS N'ÊTES PAS SÛR QUE TOUTES LES PIÈCES SOIENT PRÉSENTES.

VEUILLEZ LIRE TOUTES LES INSTRUCTIONS AVANT DE CONTINUER.

EN CAS DE DOUTE LORS DU MONTAGE DE NOS PRODUITS, CONSULTEZ UN DE NOS REVENDEURS OU FAITES APPEL À UN TECHNICIEN QUALIFIÉ.

VEUILLEZ NOTER QUE LA FAÇON DONT LE KIT EST EMBALLÉ NE REPRÉSENTE PAS NECESSAIREMENT LA MANIÈRE DE LE MONTER SUR LA MOTO.

SI DES RONDELLES EN CAOUTCHOUC SONT UTILISÉES POUR MAINTENIR LES COMPOSANTS SUR LES BOULONS, ELLES PEUVENT ÊTRE JETÉES.

NOTICE DISPONIBLE AU TÉLÉCHARGEMENT SUR :

WWW.RG-RACING.COM

R&G

Unit 1, Shelley's Lane, East Worldham, Alton, Hampshire, GU34 3AQ

Tel: +44 (0)1420 89007 Fax: +44 (0)1420 87301 www.rg-racing.com Email: info@rg-racing.com



| <u>OUTILS REQUIS</u> | <u>VALEURS DE SERRAGE</u> |
|--|---|
| <ul style="list-style-type: none"> • Clés Torx T20, T25, T30. • Clés Allen 3, 4, 5 & 6mm • Clé à cliquet + douille 6 & 8mm. <ul style="list-style-type: none"> • Tournevis cruciforme. • Petit tournevis plat. | M4 BOULON = 8Nm M5 BOULON = 12Nm M6 BOULON = 15Nm M8 BOULON = 20Nm M10 BOULON = 40Nm M12 BOULON = 40Nm |

LÉGENDE

| ARTICLE No. | DESCRIPTION | QTÉ |
|--------------------|---|------------|
| ARTICLE 1 | TB0320BK PARTIE 1 – SUPPORT PRINCIPAL CÔTÉ DROIT | 1 |
| ARTICLE 2 | TB0320BK PARTIE 2 – SUPPORT PRINCIPAL CÔTÉ GAUCHE | 1 |
| ARTICLE 3 | TB0320BK PARTIE 3 – SUPPORT DE PLAQUE | 1 |
| ARTICLE 4 | S1360 – ENTRETOISES DE MONTAGE | 4 |
| ARTICLE 5 | CON0065 – CONNECTEUR DE FEU DE PLAQUE | 1 |
| ARTICLE 6 | CON0046 – CONNECTEUR DE CLIGNOTANT | 2 |
| ARTICLE 7 | LA0002 – ASSEMBLAGE DE FEU DE PLAQUE | 1 |
| ARTICLE 8 | M5x0.8x10.0 mm VIS | 4 |
| ARTICLE 9 | M5x0.8 ÉCROUS | 4 |
| ARTICLE 10 | M5x10mm RONDELLES | 4 |
| ARTICLE 11 | REFL 3 – RÉFLECTEUR | 1 |
| ARTICLE 12 | 150mm MANCHON THERMO RÉTRACTABLE | 3 |
| ARTICLE 13 | 2.5mm COLLIERS DE SERRAGE | 6 |
| ARTICLE 14 | IWC0002 – CACHES FILS DE MINI CLIGNOTANT | 2 |
| ARTICLE 15 | CLIP 1 – CLIPS CÂBLE AUTOCOLLANT | 2 |
| ARTICLE 16 | M6 ÉCROUS | 2 |
| ARTICLE 17 | M6x1.0x15mm VIS | 2 |
| ARTICLE 18 | M6x19mm RONDELLES | 6 |

R&G

Unit 1, Shelley's Lane, East Worldham, Alton, Hampshire, GU34 3AQ

Tel: +44 (0)1420 89007 Fax: +44 (0)1420 87301 www.rg-racing.com Email: info@rg-racing.com



SCHÉMA D'ASSEMBLAGE

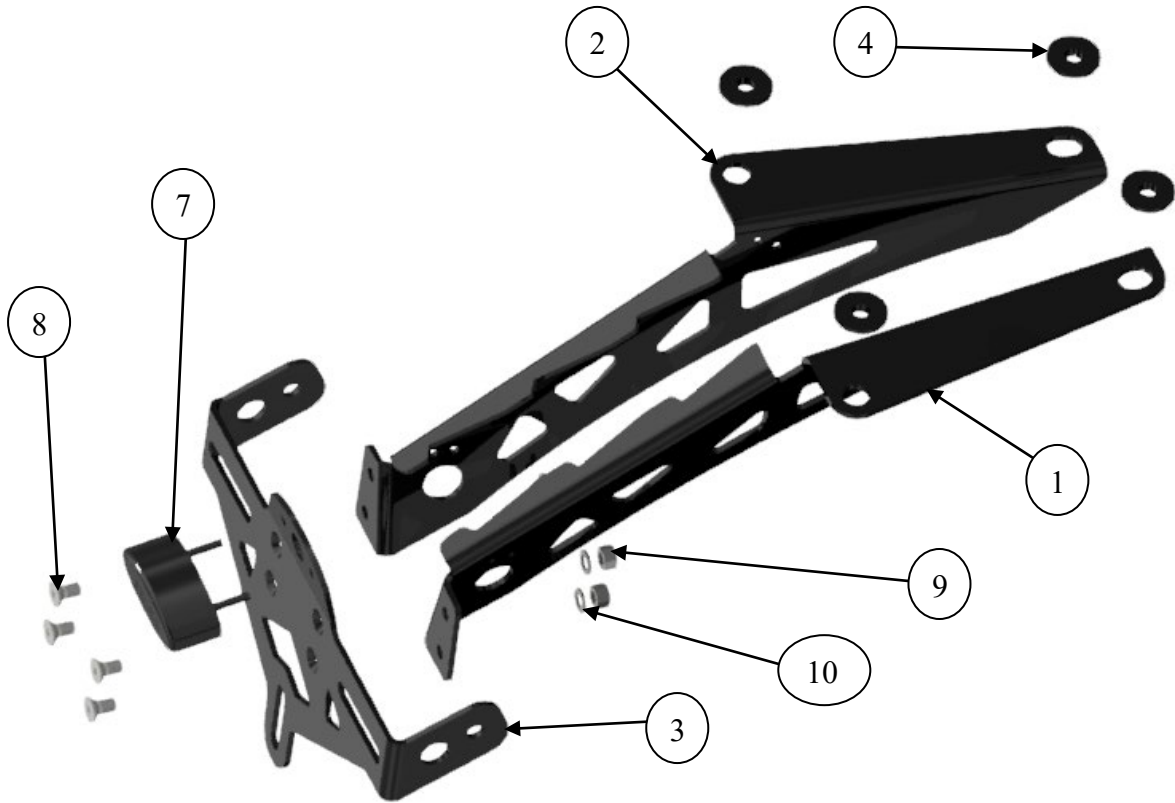

R&G

Unit 1, Shelley's Lane, East Worldham, Alton, Hampshire, GU34 3AQ

Tel: +44 (0)1420 89007 Fax: +44 (0)1420 87301 www.rg-racing.com Email: info@rg-racing.com



PHOTOS DE MONTAGE



Photo 1



Photo 2



Photo 3



Photo 4



Photo 5

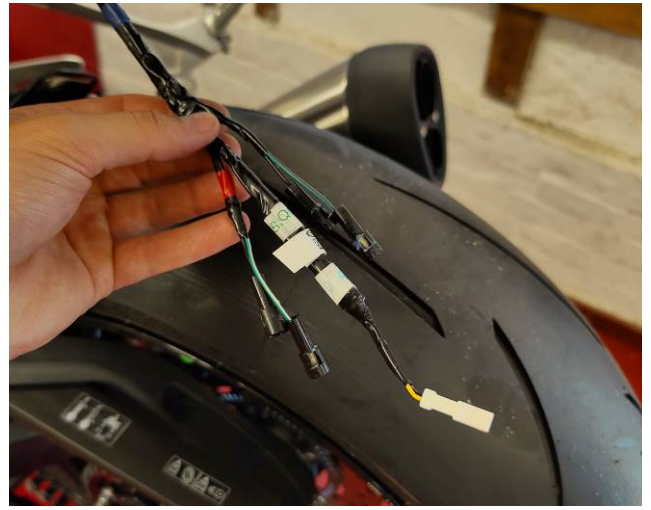

Photo 6



Photo 7



Photo 8



Photo 9



Photo 10

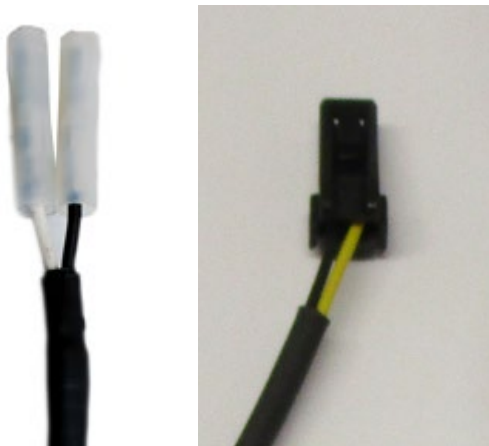

Photo 11



Photo 12



Photo 13

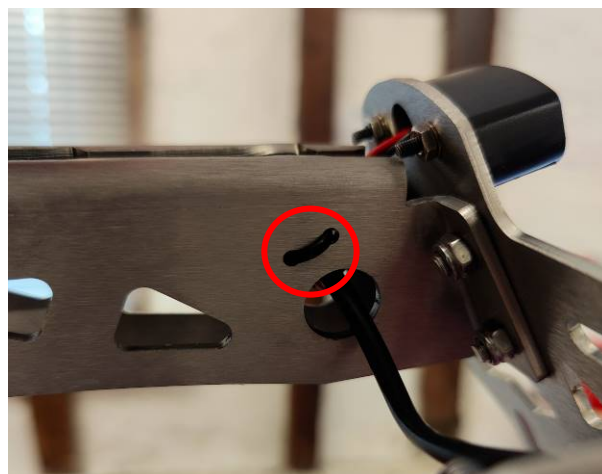

Photo 14

NOTICE DE MONTAGE

- Commencez par dévisser les boulons fixant le support de plaque d'immatriculation d'origine à l'empennage de la moto avec un tournevis Torx T20, comme indiqué sur la photo 1.
- Cela laissera le support de plaque d'immatriculation lâche et connecté uniquement par les fils de clignotants, maintenez le support de plaque d'immatriculation afin que les fils ne soient pas endommagés.
- Tirez doucement sur le couvercle en plastique pour le retirer comme indiqué sur la photo 3.
- Cela exposera les 2 vis illustrées sur la photo 4. Celles-ci doivent être retirées à l'aide d'une clé Torx T20 pour séparer les 2 moitiés du support de plaque d'immatriculation.
- Les couvercles en plastique restants peuvent maintenant être retirés avec précaution.
- Une fois les connecteurs de clignotant et de feu exposés comme indiqué sur la photo 5, déconnectez-les et retirez le support de plaque d'immatriculation d'origine, en laissant les fils illustrés sur la photo 6. (Notez quels clignotants sont connectés aux côtés gauche et droit car ils doivent être reconnectés correctement lors de la reconnexion du support R&G).

R&G

Unit 1, Shelley's Lane, East Worldham, Alton, Hampshire, GU34 3AQ

Tel: +44 (0)1420 89007 Fax: +44 (0)1420 87301 www.rg-racing.com Email: info@rg-racing.com



- Si vous utilisez les clignotants d'origine, retirez les boulons qui les maintiennent au support de plaque d'immatriculation et dévissez les fils pour les libérer. Ceux-ci peuvent ensuite être fixés au support R&G à l'aide des vis M6 et des écrous nyloc fournis.
- Assemblez le support de plaque R&G comme indiqué sur la photo 7 et la photo 8 à l'aide des attaches M5 fournies.
- Fixez le feu de plaque d'immatriculation R&G (Article 7) comme indiqué sur la Photo 9.
- Insérez les entretoises (Article 4) dans les trous de montage comme indiqué sur la Photo 10 en veillant à ce que les côtés plats soient orientés vers le haut.
- Connectez le connecteur du feu de plaque d'immatriculation CON0065 (Article 5) comme indiqué sur le côté droit de la Photo 11, aux fils de l'éclairage.
- Si vous utilisez des clignotants R&G ou de rechange, connectez le connecteur de clignotant CON0046 (article 6) aux fils de clignotant comme indiqué sur la gauche de la photo 11.
- Rebranchez les connecteurs de clignotant et de feu aux fils dépassant de l'unité arrière de la moto. Assurez-vous que les clignotants gauche et droit soient correctement connectés. (Cela peut être vérifié en mettant le contact et en vérifiant qu'ils clignotent correctement).
- Fixez le support R&G à l'unité de la moto en utilisant les mêmes 4 vis Torx qui ont été retirées du support de plaque d'immatriculation d'origine ainsi que les rondelles M6 fournies comme indiqué sur la photo 13.
- Les fils peuvent être rangés à l'aide des serre-câbles et des fentes pour serre-câbles dans le support arrière, comme indiqué sur la photo 14.

IMPORTANT: SI VOUS INSTALLEZ UNE PLAQUE D'IMMATRICULATION DE GRANDE TAILLE ET LA PLACEZ LOIN VERS LE BAS SUR LE SUPPORT DE PLAQUE D'IMMATRICULATION, IL Y A UNE FAIBLE CHANCE QUE LA PLAQUE D'IMMATRICULATION FRAPPE LA ROUE ARRIÈRE SOUS L'EFFET D'UNE CHARGE LOURDE ET SUR DE GRANDES BOSSES SUR LA ROUTE. IL EST DE VOTRE RESPONSABILITÉ DE VÉRIFIER CETTE POSSIBILITÉ ET DE PRENDRE DES MESURES POUR L'ÉVITER. NE PAS VÉRIFIER CECI POURRAIT ENTRAÎNER DES BLESSURES GRAVES.

ISSUE 1 - 30/07/2021 - (WW)

CONSUMER NOTICE

The catalogue description and any exhibition of samples are only broad indications of the Products and R&G may make design changes which do not diminish their performance or visual appeal and supplying them in such state shall conform to the order. The Buyer acknowledges no representation or warranty (other than as to title) has been given or will apply to the Products other than those in R&G's order or confirmation and the Buyer confirms it has chosen the Products as being of merchantable quality and suitable for its particular purposes. Where R&G fits the Products or undertakes other services it shall exercise reasonable skill and care and rectify any fault free of charge unless the workmanship has been disturbed. The Buyer is responsible for ensuring that the warranty on the motorcycle is not affected by the fitting of the Products. On return of any defective Products R&G shall at its option either supply a replacement or refund the purchase money but shall not be liable if the Products have been modified or used or maintained otherwise than in accordance with R&G's or manufacturer's instructions and good engineering practice or if the defect arises from accident or neglect. Other than identified above and subject to R&G not limiting its liability for causing death and personal injury, it shall not be liable for indirect or consequential loss and otherwise its liability shall be limited to the amounts paid by the Buyer for the Products or the fitting or service concerned. These terms do not affect the Buyer's statutory rights.

R&G RACING RETURNS POLICY (NON-FAULTY GOODS)

Returns must be pre-authorized (if not pre-authorized the return will be rejected). Goods may only be returned direct to us if they were purchased direct from us (customer must prove if necessary). Otherwise to be returned to original vendor. Goods must be in re-sellable condition, in the opinion of R&G Racing. All returns are subject to

R&G

Unit 1, Shelley's Lane, East Worldham, Alton, Hampshire, GU34 3AQ

Tel: +44 (0)1420 89007 Fax: +44 (0)1420 87301 www.rg-racing.com Email: info@rg-racing.com



a 25% restocking and handling fee (25% of the gross value exc. P&P – at the prevailing price at time of purchase). The customer must pay any and all carriage charges. No returns of discontinued products, unless within 14 days of purchase. This policy does not affect your statutory rights and does not refer to faulty goods.

R&G

Unit 1, Shelley's Lane, East Worldham, Alton, Hampshire, GU34 3AQ

Tel: +44 (0)1420 89007 Fax: +44 (0)1420 87301 www.rg-racing.com Email: info@rg-racing.com



MONTAGEANLEITUNG FÜR LP0320 KENNZEICHENHALTER
TRIUMPH SPEED TRIPLE 1200 RS 2021-



Alle Kit-Teile sind auf den nachfolgenden Seiten abgebildet und gekennzeichnet.

Die abgebildeten Teile dienen lediglich zur Erklärung.

Überprüfen Sie zuerst, dass alle Teile vorhanden sind.

Lesen Sie die Montageanleitung komplett durch, bevor Sie anfangen.

WENN SIE BEI DER MONTAGE DIESES PRODUKTES UNSICHER SIND, BITTE EINEN
UNSERER HÄNDLER KONTAKTIEREN ODER DAS KIT VON EINEM QUALIFIZIERTEN
ZWEIRAD-MECHANIKER MONTIEREN LASSEN.

DIE VERPACKUNG DER TEILE STELLT NICHT DIE REIHENFOLGE DER MONTAGE DAR.

HINWEIS FÜR KITS MIT PLASTIKUNTERLEGSCHLEIBEN AN DEN SCHRAUBEN –
DIESE PLASTIK-UNTERLEGSCHLEIBEN WERDEN NICHT FÜR DEN EINBAU BENÖTIGT

EINE DIGITALE VERSION DIESER MONTAGEANLEITUNG KANN AUF
FOLGENDER SEITE HERUNTERGELADEN WERDEN: [WWW.RG-RACING.COM](http://www.rg-racing.com)

R&G

Unit 1, Shelley's Lane, East Worldham, Alton, Hampshire, GU34 3AQ
Tel: +44 (0)1420 89007 Fax: +44 (0)1420 87301 www.rg-racing.com Email: info@rg-racing.com



| <u>SIE BENÖTIGEN FOLGENDES WERKZEUG</u> | <u>ALLGEM. ANZUGSDREHMOMENT</u> |
|---|--|
| <ul style="list-style-type: none"> • Satz Torx-Schlüssel inkl. T20, T25, T30. • Satz Inbusschlüssel inkl. 3, 4, 5 & 6mm • 6 & 8mm Schraubenschlüssel oder Steckschlüssel • Kreuzschlitz-Schraubendreher • Flachklingen-Schraubendreher | <p>M4 SCHRAUBE = 8Nm M5 SCHRAUBE = 12Nm M6 SCHRAUBE = 15Nm M8 SCHRAUBE = 20Nm M10 SCHRAUBE = 40Nm M12 SCHRAUBE = 40Nm</p> |

LIEFERUMFANG

| ARTIKEL NR. | BESCHREIBUNG | MENGE |
|--------------------|---|--------------|
| ARTIKEL 1 | TB0320BK TEIL 1 – HAUPTHALTERUNG RECHTE SEITE | 1 |
| ARTIKEL 2 | TB0320BK TEIL 2 – HAUPTHALTERUNG LINKE SEITE | 1 |
| ARTIKEL 3 | TB0320BK TEIL 3 – KENNZEICHENHALTER | 1 |
| ARTIKEL 4 | S1360 – MONTAGE-DISTANZHALTER | 4 |
| ARTIKEL 5 | CON0065 – VERBINDUNG KENNZEICHENBELEUCHTUNG | 1 |
| ARTIKEL 6 | CON0046 - BLINKERVERBINDUNG | 2 |
| ARTIKEL 7 | LA0002 – KENNZEICHENBELEUCHTUNGSEINHEIT | 1 |
| ARTIKEL 8 | M5x0.8x10.0 mm SENKSCHRAUBE | 4 |
| ARTIKEL 9 | M5x0.8 SELBSTSICHERNDE MUTTER | 4 |
| ARTIKEL 10 | M5x10mm UNTERLEGSCHIEBE | 4 |
| ARTIKEL 11 | REFL 3 - RÜCKSTAHLER | 1 |
| ARTIKEL 12 | 150mm SCHRUMPFSCHLAUCH | 3 |
| ARTIKEL 13 | 2.5mm KABELBINDER | 6 |
| ARTIKEL 14 | IWC0002 – MINIBLINKER KABEL-ABDECKUNG | 2 |
| ARTIKEL 15 | CLIP 1 – SELBSTSICHERNDE KABELCLIP | 2 |
| ARTIKEL 16 | M6 SELBSTSICHERNDE MUTTER | 2 |
| ARTIKEL 17 | M6x1.0x15mm INBUSSCHRAUBE | 2 |
| ARTIKEL 18 | M6x19mm UNTERLEGSCHIEBE | 6 |

R&G

Unit 1, Shelley's Lane, East Worldham, Alton, Hampshire, GU34 3AQ

Tel: +44 (0)1420 89007 Fax: +44 (0)1420 87301 www.rg-racing.com Email: info@rg-racing.com



ZUSAMMENBAU ZEICHNUNG

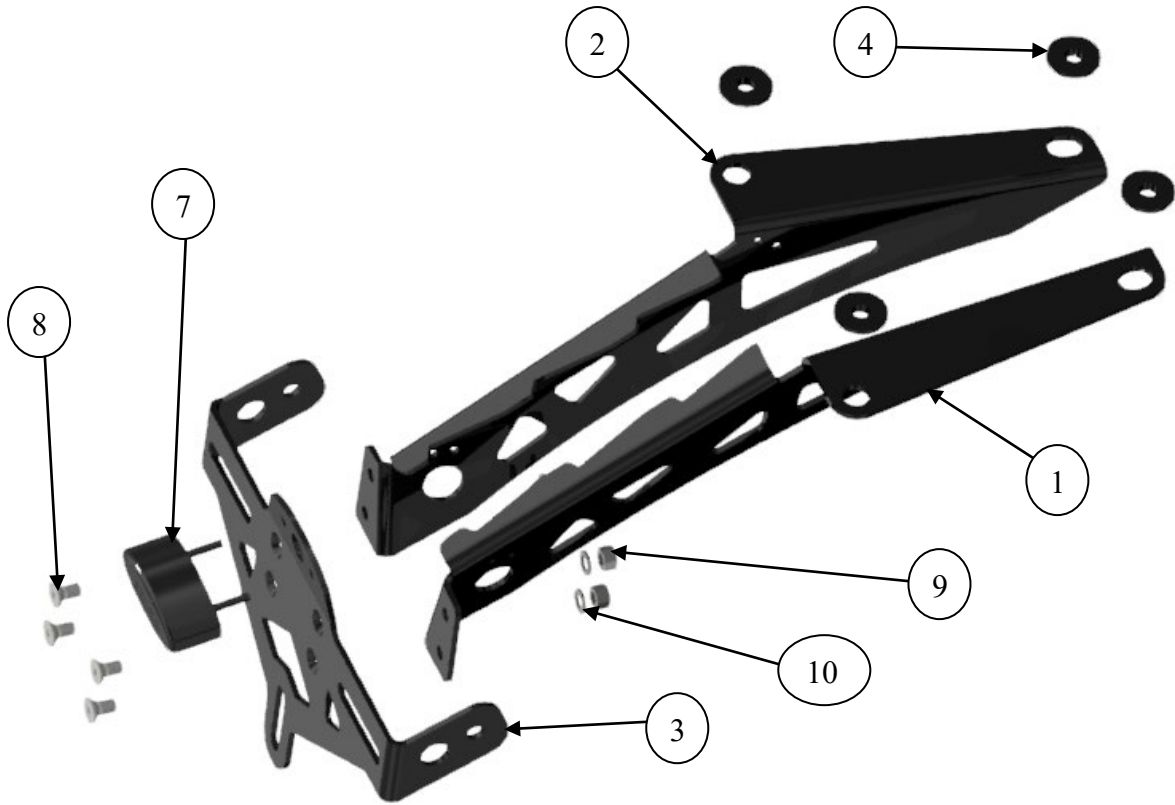

R&G

Unit 1, Shelley's Lane, East Worldham, Alton, Hampshire, GU34 3AQ

Tel: +44 (0)1420 89007 Fax: +44 (0)1420 87301 www.rg-racing.com Email: info@rg-racing.com



MONTAGE BILDER



Abbildung 1



Abbildung 2



Abbildung 3



Abbildung 4



Abbildung 5



Abbildung 6

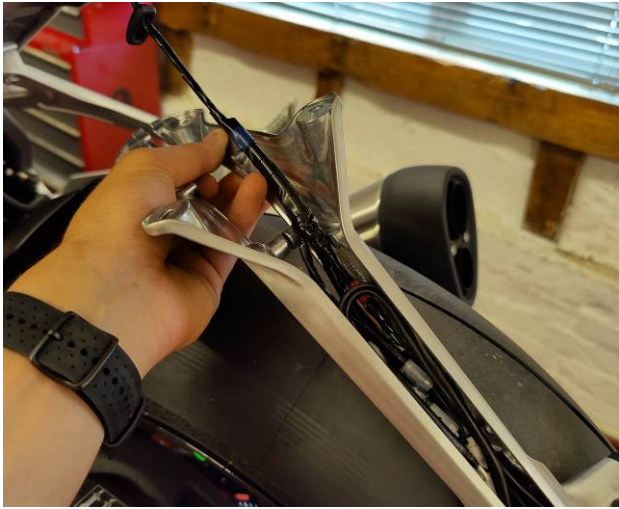

Abbildung 7

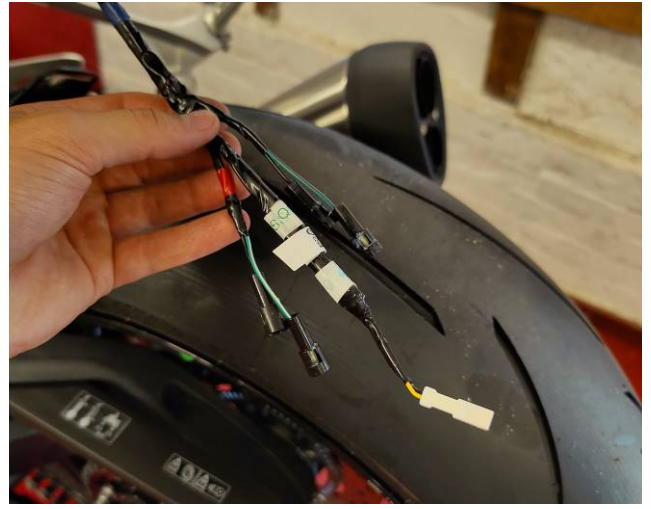

Abbildung 8



Abbildung 9



Abbildung 10

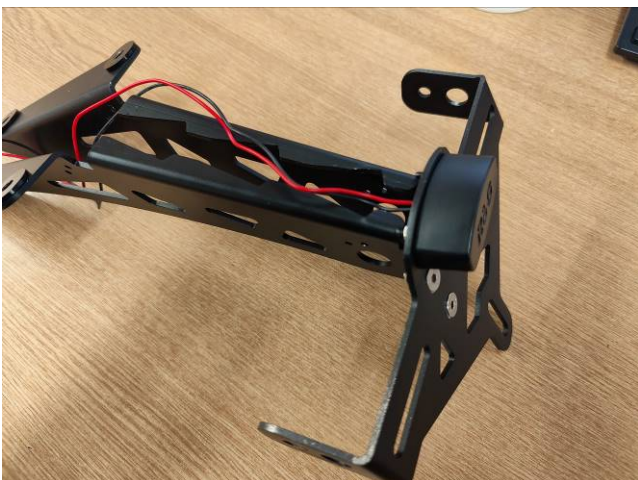

Abbildung 11



Abbildung 12

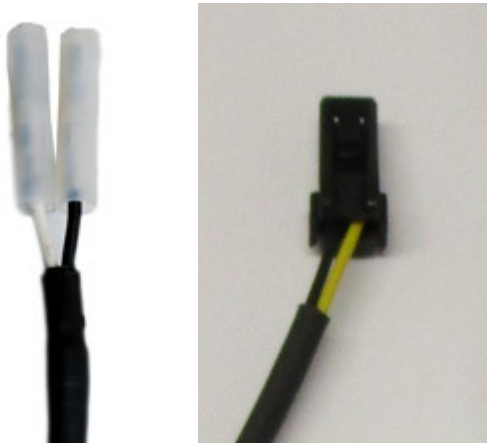

Abbildung 13



Abbildung 14

MONTAGEANLEITUNG

- Fangen Sie an, indem Sie die Schrauben mit einem T20 Torx-Schlüssel lösen, die den original Kennzeichenhalter am Heck befestigen wie in **Abbildung 1** abgebildet.
- Der Kennzeichenhalter sitzt nun locker und ist nur durch die Kabel für die Blinker verbunden. Stützen Sie daher den Kennzeichenhalter, sodass die Kabel nicht beschädigt werden.
- Das Verkleidungsteil aus Kunststoff hochziehen, um es zu entfernen wie in **Abbildung 3** abgebildet.
- Danach sehen Sie die 2 Schrauben, die in **Abbildung 4** abgebildet sind. Diese müssen mit einem T20 Torx-Schlüssel entfernt werden, um den Kennzeichenhalter in zwei Teile zu trennen.
- Die übrigen Kunststoffabdeckungen können nun vorsichtig entfernt werden.
- Nachdem die Verbindungen für die Blinker und die Kennzeichenbeleuchtung zu sehen sind (siehe **Abbildung 5**), trennen Sie dies und entfernen Sie den Kennzeichenhalter. Die Kabel so lassen wie in **Abbildung 6** abgebildet. (Bitte notieren Sie wie die Blinker angeschlossen waren – linke und rechte Seite – sodass Sie diese später am R&G Kennzeichenhalter richtig montiert werden können.)
- Wenn Sie es vorhaben, die Originalblinker wieder zu montieren, entfernen Sie die Schrauben, die die Blinker am Kennzeichenhalter befestigen und die Kabel ausfädeln. Diese können dann

R&G

Unit 1, Shelley's Lane, East Worldham, Alton, Hampshire, GU34 3AQ

Tel: +44 (0)1420 89007 Fax: +44 (0)1420 87301 www.rg-racing.com Email: info@rg-racing.com



am R&G Kennzeichenhalter mit den M6 Schrauben und selbstsichernden Muttern vom Kit gesichert werden.

- Den R&G Kennzeichenhalter mit den M5 Befestigungssteilen vom Kit zusammenbauen wie in **Abbildung 7** und **Abbildung 8** abgebildet.
- Die Kennzeichenbeleuchtung (**Artikel 7**) anbringen wie in **Abbildung 9** abgebildet.
- Die Distanzhalter (**Artikel 4**) in die Montageöffnungen einsetzen wie in **Abbildung 10** abgebildet mit der flachen Fläche nach oben gerichtet.
- Verbinden Sie die CON0065 Verbindung für die Kennzeichenbeleuchtung (**Artikel 5**) mit den Kabeln für die Kennzeichenbeleuchtung wie in **Abbildung 11** abgebildet.
- Wenn Sie R&G Blinker oder Blinker aus dem Zubehörmarkt montieren, verbinden Sie die CON0046 Verbindung (**Artikel 6**) mit den Kabeln für die Blinker wie auf der linken Seite in **Abbildung 11** abgebildet.
- Verbinden Sie die Blinker- und Beleuchtungsverbindungen wieder mit den Kabeln, die am Heck des Motorrades hervorstehen. Stellen Sie sicher, dass die rechte und linke Blinker richtig angeschlossen sind. (Dies können Sie überprüfen, indem Sie die Zündung einschalten und kontrollieren, dass die Blinker entsprechend blinken.)
- Den R&G Kennzeichenhalter am Heck des Motorrades montieren – benutzen Sie dieselben 4 Torx-Schrauben, die vom original Kennzeichenhalter entfernt wurden sowie die M6 Unterlegscheiben vom Kit wie in **Abbildung 13** abgebildet.
- Die Kabel mittels Kabelbinder und Schlitze für die Kabelbinder im Kennzeichenhalter ordentlich verstauen wie in **Abbildung 14** abgebildet.

WICHTIG: WENN EIN GROSSES KENNZEICHEN ZU WEIT NACH UNTEN MONTIERT WIRD, BESTEHT BEI SCHWERER LAST ODER DURCH GROSSE BODENWELLEN EIN GERINGES RISIKO, DASS DAS KENNZEICHEN AN DAS HINTERRAD STOSSEN KANN. ES LIEGT IN IHRER VERANTWORTUNG DIES ZU ÜBERPRÜFEN UND, WENN NOTWENDIG, ZU VORBEUGENDEN MASSNAHMEN ZU ERGREIFEN. DIE NICHTBEACHTUNG DIESER SICHERHEITSHINWEISES KANN ZU SCHWEREN VERLETZUNGEN FÜHREN.

0

AUSGABE 1 - 30/07/2021 - (WW)

CONSUMER NOTICE

The catalogue description and any exhibition of samples are only broad indications of the Products and R&G may make design changes which do not diminish their performance or visual appeal and supplying them in such state shall conform to the order. The Buyer acknowledges no representation or warranty (other than as to title) has been given or will apply to the Products other than those in R&G's order or confirmation and the Buyer confirms it has chosen the Products as being of merchantable quality and suitable for its particular purposes. Where R&G fits the Products or undertakes other services it shall exercise reasonable skill and care and rectify any fault free of charge unless the workmanship has been disturbed. The Buyer is responsible for ensuring that the warranty on the motorcycle is not affected by the fitting of the Products. On return of any defective Products R&G shall at its option either supply a replacement or refund the purchase money but shall not be liable if the Products have been modified or used or maintained otherwise than in accordance with R&G's or manufacturer's instructions and good engineering practice or if the defect arises from accident or neglect. Other than identified above and subject to R&G not limiting its liability for causing death and personal injury, it shall not be liable for indirect or consequential loss and otherwise its liability shall be limited to the amounts paid by the Buyer for the Products or the fitting or service concerned. These terms do not affect the Buyer's statutory rights.

R&G RACING RETURNS POLICY (NON-FAULTY GOODS)

Returns must be pre-authorized (if not pre-authorized the return will be rejected). Goods may only be returned direct to us if they were purchased direct from us (customer must prove if necessary). Otherwise to be returned to original vendor. Goods must be in re-sellable condition, in the opinion of R&G Racing. All returns are subject to a 25% restocking and handling fee (25% of the gross value exc. P&P – at the prevailing price at time of purchase). The customer must pay any and all carriage charges. No returns of discontinued products, unless within 14 days of purchase. This policy does not affect your statutory rights and does not refer to faulty goods.

R&G

Unit 1, Shelley's Lane, East Worldham, Alton, Hampshire, GU34 3AQ

Tel: +44 (0)1420 89007 Fax: +44 (0)1420 87301 www.rg-racing.com Email: info@rg-racing.com