



FITTING INSTRUCTIONS FOR HLG0017 HEADLIGHT GUARD



THIS KIT CONTAINS THE ITEMS PICTURED AND LABELLED OVER PAGE.

SOME PARTS MAY BE SHOWN FOR CLARITY OF INSTRUCTIONS ONLY.

DO NOT PROCEED UNTIL YOU ARE SURE ALL PARTS ARE PRESENT.

PLEASE READ ALL INSTRUCTIONS BEFORE PROCEEDING.

**IF IN ANY DOUBT WHEN FITTING OUR PRODUCTS, CONSULT ONE OF OUR DEALERS
OR HAVE FITTED BY A QUALIFIED TECHNICIAN.**

PLEASE NOTE THAT THE WAY THE KIT IS PACKED DOES NOT NECESSARILY REPRESENT THE WAY OF
MOUNTING TO THE BIKE.

IN THE EVENT OF RUBBER WASHERS BEING USED TO HOLD COMPONENTS ONTO BOLTS,
THESE RUBBER WASHERS CAN BE THROWN AWAY.

DIGITAL COPIES OF THESE INSTRUCTIONS ARE AVAILABLE FROM:

WWW.RG-RACING.COM

Racing Technique Ltd t/A R&G
Unit 1, Shelleys Lane, East Worldham, Alton, Hampshire, GU 34 3AQ
Tel: +44 (0)1420 89007 www.rg-racing.com Email: infor@rg-racing.com



<u>TOOLS REQUIRED</u> <ul style="list-style-type: none"> • 3mm ALLEN TOOL • T25 TORX TOOL • 8mm SPANNER 	<u>GENERAL TORQUE SETTINGS</u> <p>M4 BOLT = 8Nm M5 BOLT = 12Nm M6 BOLT = 15Nm M8 BOLT = 20Nm M10 BOLT = 40Nm M12 BOLT = 40Nm</p>
---	--

LEGEND

ITEM NO.	DESCRIPTION	QTY
ITEM 1	STAINLESS HEADLIGHT GUARD FRAME	1
ITEM 2	CENTRE MOUNT	1
ITEM 3	LHS MOUNT	1
ITEM 4	RHS MOUNT	1
ITEM 5	THREADED SPACER	1
ITEM 6	M5 x 10mm BUTTON HEAD BOLT	2
ITEM 7	M5 x 12mm BUTTON HEAD BOLT	4
ITEM 8	M5 x 15mm BUTTON HEAD BOLT	2
ITEM 9	M5 WELL NUT	4
ITEM 10	M5 WASHER	10
ITEM 11	M5 NUT	2

ASSEMBLY DIAGRAM

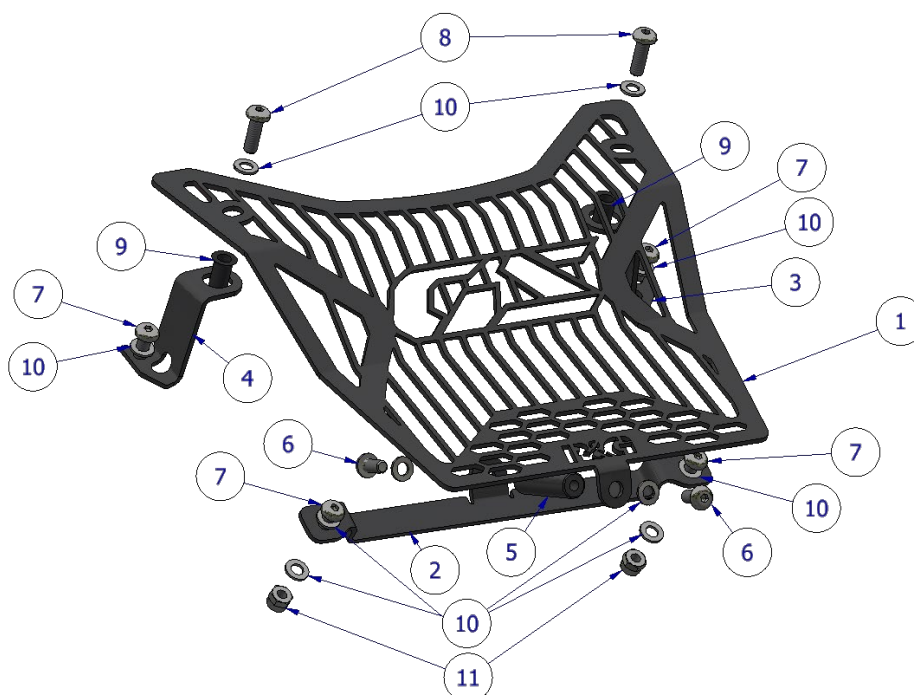



FITTING PICTURES

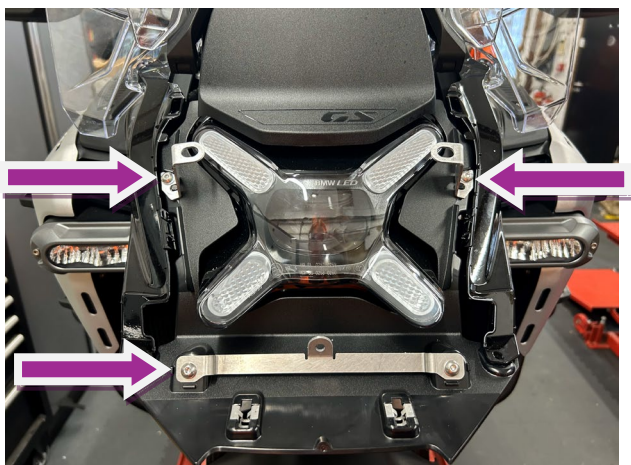

Picture 1



Picture 2



Picture 3

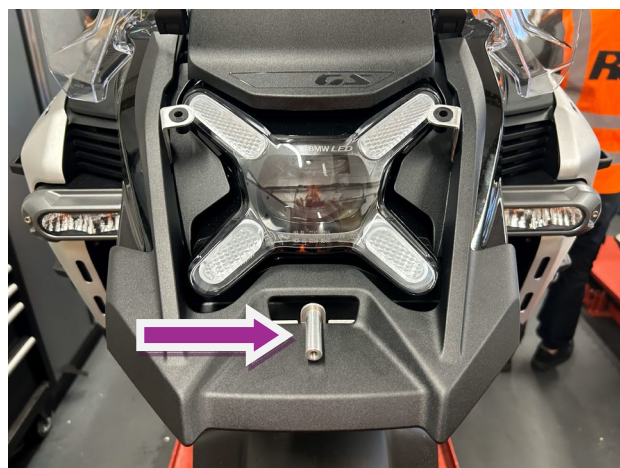

Picture 4

FITTING INSTRUCTIONS

- To fit the R&G headlight guard, first remove the 2x torx head bolts securing the headlight shroud on the underside of the beak, you can then pull up on the shroud to remove it.
- Fit **items 2-4** to the bike as shown in **Pictures 1 & 2**, paying close attention to the orientation of **Items 3 & 4**, using the bolts, washers & nuts as shown in the **assembly diagram**.
- Refit the headlight cowl and insert the well nuts (**Item 9**) as shown in **picture 3**.
- Fit the threaded spacer (**Item 5**) as shown in **picture 4**. The headlight guard can then be fitted to the mounts. Please refer to the **assembly diagram** to ensure the correct bolts & washers are used.
- Ensure all bolts are tight before riding, check bolts regularly.

ISSUE 1 – 29/01/2025 (MH)

**CONSUMER NOTICE**

The catalogue description and any exhibition of samples are only broad indications of the Products and R&G may make design changes which do not diminish their performance or visual appeal and supplying them in such state shall conform to the order. The Buyer acknowledges no representation or warranty (other than as to title) has been given or will apply to the Products other than those in R&G's order or confirmation and the Buyer confirms it has chosen the Products as being of merchantable quality and suitable for its particular purposes. Where R&G fits the Products or undertakes other services it shall exercise reasonable skill and care and rectify any fault free of charge unless the workmanship has been disturbed. The Buyer is responsible for ensuring that the warranty on the motorcycle is not affected by the fitting of the Products. On return of any defective Products R&G shall at its option either supply a replacement or refund the purchase money but shall not be liable if the Products have been modified or used or maintained otherwise than in accordance with R&G's or manufacturer's instructions and good engineering practice or if the defect arises from accident or neglect. Other than identified above and subject to R&G not limiting its liability for causing death and personal injury, it shall not be liable for indirect or consequential loss and otherwise its liability shall be limited to the amounts paid by the Buyer for the Products or the fitting or service concerned. These terms do not affect the Buyer's statutory rights.

R&G RACING RETURNS POLICY (NON-FAULTY GOODS)

Returns must be pre-authorized (if not pre-authorized the return will be rejected). Goods may only be returned direct to us if they were purchased direct from us (customer must prove if necessary). Otherwise to be returned to original vendor. Goods must be in re-sellable condition, in the opinion of R&G Racing. All returns are subject to a 25% restocking and handling fee (25% of the gross value exc. P&P – at the prevailing price at time of purchase). The customer must pay any and all carriage charges. No returns of discontinued products, unless within 14 days of purchase. This policy does not affect your statutory rights and does not refer to faulty goods.



NOTICE DE MONTAGE HLG0017 PROTECTION DE PHARE



CE KIT CONTIENT LES ARTICLES ILLUSTRÉS ET ÉTIQUETES SUR LA PAGE.

CERTAINES PARTIES PEUVENT ÊTRE PRÉSENTES UNIQUEMENT POUR LA CLARTÉ DES INSTRUCTIONS.

NE PAS PROCÉDER AU MONTAGE TANT QUE VOUS N'ÊTES PAS SÛR QUE TOUTES LES PIÈCES SOIENT PRÉSENTES.

VEUILLEZ LIRE TOUTES LES INSTRUCTIONS AVANT DE CONTINUER.

**EN CAS DE DOUTE LORS DU MONTAGE DE NOS PRODUITS, CONSULTEZ UN DE NOS
REVENDEURS OU FAITES APPEL À UN TECHNICIEN QUALIFIÉ.**

VEUILLEZ NOTER QUE LA FAÇON DONT LE KIT EST EMBALLÉ NE REPRÉSENTE PAS NECESSAIREMENT LA
MANIÈRE DE LE MONTER SUR LA MOTO.

SI DES RONDELLES EN CAOUTCHOUC SONT UTILISÉES POUR MAINTENIR LES COMPOSANTS SUR LES BOULONS,
ELLES PEUVENT ÊTRE JETÉES.

NOTICE DISPONIBLE AU TÉLÉCHARGEMENT SUR :

WWW.RG-RACING.COM



<u>OUTILS REQUIS</u>	<u>VALEURS DE SERRAGE</u>
<ul style="list-style-type: none"> • CLÉ ALLEN 3mm • CLÉ TORX T25 • CLÉ À MOLETTE 8mm SPANNER 	M4 BOULON = 8Nm M5 BOULON = 12Nm M6 BOULON = 15Nm M8 BOULON = 20Nm M10 BOULON = 40Nm M12 BOULON = 40Nm

LÉGENDE

ARTICLE No.	DESCRIPTION	QTÉ
ARTICLE 1	CADRE DE PROTECTION DE PHARE EN ACIER INOXYDABLE	1
ARTICLE 2	SUPPORT CENTRAL	1
ARTICLE 3	SUPPORT CÔTÉ GAUCHE	1
ARTICLE 4	SUPPORT CÔTÉ DROIT	1
ARTICLE 5	ENTRETOISE FILETÉE	1
ARTICLE 6	M5 x 10mm BOULON	2
ARTICLE 7	M5 x 12mm BOULON	4
ARTICLE 8	M5 x 15mm BOULON	2
ARTICLE 9	M5 ÉCROU	4
ARTICLE 10	M5 RONDELLE	10
ARTICLE 11	M5 ÉCROU	2

SCHEMA D'ENSEMBLE

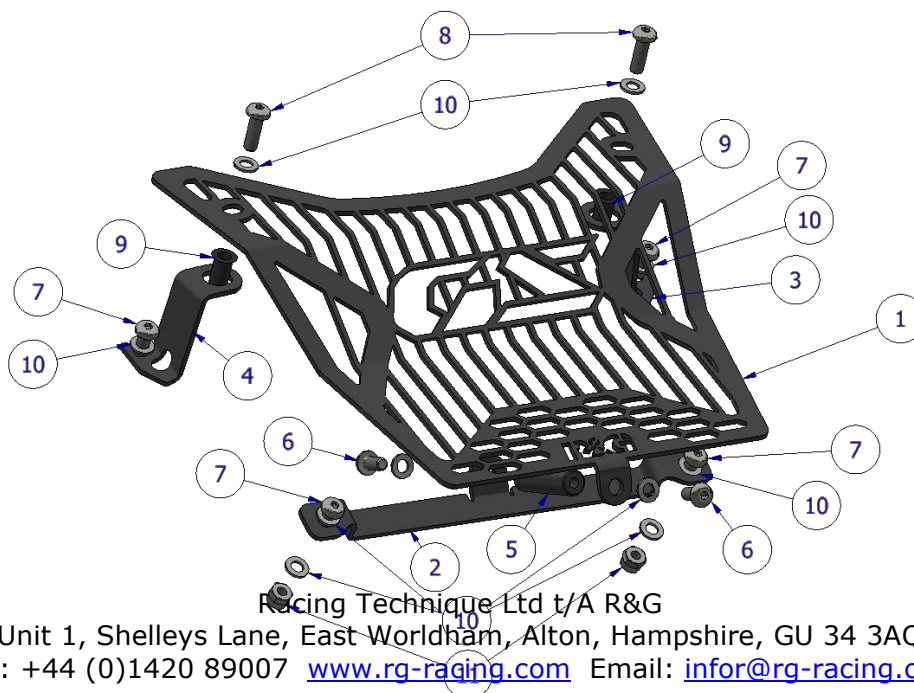



PHOTOS DE MONTAGE

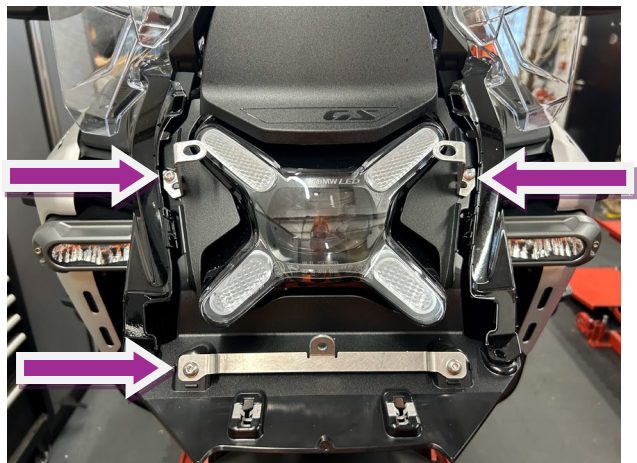

Photo 1



Photo 2



Photo 3



Photo 4

NOTICE DE MONTAGE

- Pour installer la protection de phare R&G, retirez d'abord les 2 boulons à tête Torx qui fixent le carénage du phare sur la face inférieure du bec, vous pouvez ensuite tirer sur le carénage pour le retirer.
- Montez les articles 2 à 4 sur la moto comme indiqué sur les photos 1 et 2, en faisant très attention à l'orientation des articles 3 et 4, en utilisant les boulons, les rondelles et les écrous comme indiqué sur le schéma de montage.
- Remontez le capot de phare et insérez les écrous (article 9) comme indiqué sur la photo 3.
- Montez l'entretoise filetée (article 5) comme indiqué sur la photo 4. La protection de phare peut ensuite être montée sur les supports. Veuillez vous référer au schéma de montage pour vous assurer que les boulons et les rondelles appropriés soient utilisés.

Racing Technique Ltd t/A R&G

Unit 1, Shelleys Lane, East Worldham, Alton, Hampshire, GU 34 3AQ

Tel: +44 (0)1420 89007 www.rg-racing.com Email: infor@rg-racing.com



- Assurez-vous que tous les boulons soient bien serrés avant de rouler, vérifiez les boulons régulièrement.

ISSUE 1 – 29/01/2025 (MH)

CONSUMER NOTICE

The catalogue description and any exhibition of samples are only broad indications of the Products and R&G may make design changes which do not diminish their performance or visual appeal and supplying them in such state shall conform to the order. The Buyer acknowledges no representation or warranty (other than as to title) has been given or will apply to the Products other than those in R&G's order or confirmation and the Buyer confirms it has chosen the Products as being of merchantable quality and suitable for its particular purposes. Where R&G fits the Products or undertakes other services it shall exercise reasonable skill and care and rectify any fault free of charge unless the workmanship has been disturbed. The Buyer is responsible for ensuring that the warranty on the motorcycle is not affected by the fitting of the Products. On return of any defective Products R&G shall at its option either supply a replacement or refund the purchase money but shall not be liable if the Products have been modified or used or maintained otherwise than in accordance with R&G's or manufacturer's instructions and good engineering practice or if the defect arises from accident or neglect. Other than identified above and subject to R&G not limiting its liability for causing death and personal injury, it shall not be liable for indirect or consequential loss and otherwise its liability shall be limited to the amounts paid by the Buyer for the Products or the fitting or service concerned. These terms do not affect the Buyer's statutory rights.

R&G RACING RETURNS POLICY (NON-FAULTY GOODS)

Returns must be pre-authorized (if not pre-authorized the return will be rejected). Goods may only be returned direct to us if they were purchased direct from us (customer must prove if necessary). Otherwise to be returned to original vendor. Goods must be in re-sellable condition, in the opinion of R&G Racing. All returns are subject to a 25% restocking and handling fee (25% of the gross value exc. P&P – at the prevailing price at time of purchase). The customer must pay any and all carriage charges. No returns of discontinued products, unless within 14 days of purchase. This policy does not affect your statutory rights and does not refer to faulty goods.