



FITTING INSTRUCTIONS FOR FP0288 FORK PROTECTORS



THIS KIT CONTAINS THE ITEMS PICTURED AND LABELLED OVER PAGE.

SOME PARTS MAY BE SHOWN FOR CLARITY OF INSTRUCTIONS ONLY.

DO NOT PROCEED UNTIL YOU ARE SURE ALL PARTS ARE PRESENT.

PLEASE READ ALL INSTRUCTIONS BEFORE PROCEEDING.

**IF IN ANY DOUBT WHEN FITTING OUR PRODUCTS, CONSULT ONE OF OUR DEALERS
OR HAVE FITTED BY A QUALIFIED TECHNICIAN.**

PLEASE NOTE THAT THE WAY THE KIT IS PACKED DOES NOT NECESSARILY REPRESENT THE WAY OF
MOUNTING TO THE BIKE.

IN THE EVENT OF RUBBER WASHERS BEING USED TO HOLD COMPONENTS ONTO BOLTS,
THESE RUBBER WASHERS CAN BE THROWN AWAY.

DIGITAL COPIES OF THESE INSTRUCTIONS ARE AVAILABLE FROM:

WWW.RG-RACING.COM

R&G Racing
Unit 1, Shelley's Lane, East Worldham, Alton, Hampshire, GU34 3AQ
Tel: +44 (0)1420 89007 Fax: +44 (0)1420 87301 www.rg-racing.com Email: info@rg-racing.com



<u>TOOLS REQUIRED</u>	<u>GENERAL TORQUE SETTINGS</u>
<ul style="list-style-type: none"> X2 13mm SOCKETS 	M4 BOLT = 8Nm M5 BOLT = 12Nm M6 BOLT = 15Nm M8 BOLT = 20Nm M10 BOLT = 40Nm M12 BOLT = 40Nm

LEGEND

ITEM NO.	DESCRIPTION	QTY
ITEM 1	BOBBIN: B0442 M8	2
ITEM 2	LHS SPACER: S1312	1
ITEM 3	RHS SPACER: S1313	1
ITEM 4	M8 x 1.25 NYLOC NUTS	2
ITEM 5	M8 WASHER (19mm O/D)	2
ITEM 6	SPINDLE BAR: SB140 (M8 x 320mm LONG)	1

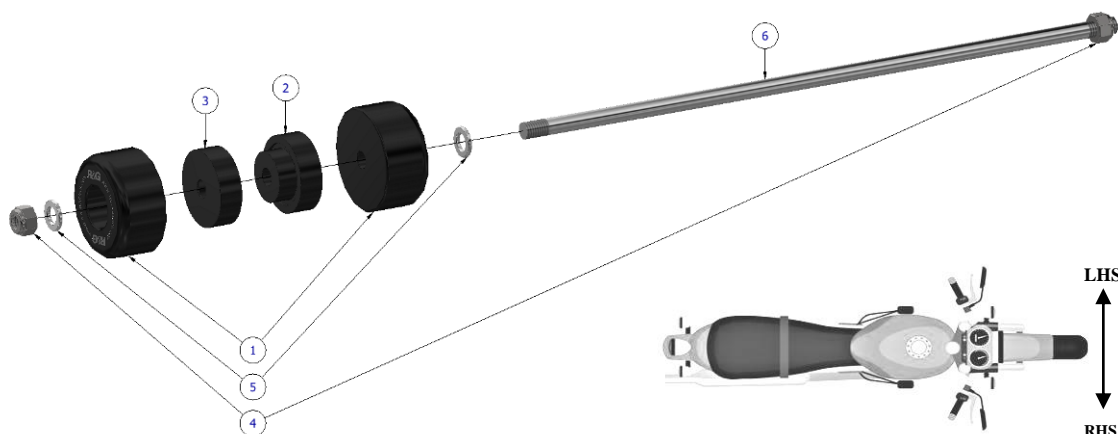

FITTING INSTRUCTIONS

- Hand tighten 1x M8 Nyloc nut (**Item 4**) to one end of the spindle bar (**Item 6**).
- Hold the spindle bar vertically with the nut at the bottom end of the bar.
- Slide 1x M8 washer (**Item 5**) down the bar, followed by 1x Bobbin (**Item 1**) & the LHS spacer (**Item 2**) in the orientation shown above.
- Slide the assembly through the **Left-hand side (LHS)** of the front wheel spindle ensuring the spacer fits snugly into the spindle.
- Insert the RHS spacer (**Item 3**) on to the protruding RHS of the spindle bar, followed by the remaining bobbin, M8 washer & Nyloc nut.

R&G Racing

Unit 1, Shelley's Lane, East Worldham, Alton, Hampshire, GU34 3AQ

Tel: +44 (0)1420 89007 Fax: +44 (0)1420 87301 www.rg-racing.com Email: info@rg-racing.com



- Evenly tighten the nuts on either side of the spindle bar until the Nyloc has engaged on both ends & the bobbins no longer rotate freely (but can still be rotated by hand).

Note: Do not over tighten & ensure a similar amount of thread is protruding from the nuts on each side of the spindle bar.

(This is more easily achieved by applying a small amount of thread lock or super glue to **ONE** of the nuts once it has around 3mm of thread protruding from the outer face).



ISSUE 1 - 29/02/2024 (MH)

CONSUMER NOTICE

The catalogue description and any exhibition of samples are only broad indications of the Products and R&G may make design changes which do not diminish their performance or visual appeal and supplying them in such state shall conform to the order. The Buyer acknowledges no representation or warranty (other than as to title) has been given or will apply to the Products other than those in R&G's order or confirmation and the Buyer confirms it has chosen the Products as being of merchantable quality and suitable for its particular purposes. Where R&G fits the Products or undertakes other services it shall exercise reasonable skill and care and rectify any fault free of charge unless the workmanship has been disturbed. The Buyer is responsible for ensuring that the warranty on the motorcycle is not affected by the fitting of the Products. On return of any defective Products R&G shall at its option either supply a replacement or refund the purchase money but shall not be liable if the Products have been modified or used or maintained otherwise than in accordance with R&G's or manufacturer's instructions and good engineering practice or if the defect arises from accident or neglect. Other than identified above and subject to R&G not limiting its liability for causing death and personal injury, it shall not be liable for indirect or consequential loss and otherwise its liability shall be limited to the amounts paid by the Buyer for the Products or the fitting or service concerned. These terms do not affect the Buyer's statutory rights.

R&G RACING RETURNS POLICY (NON-FAULTY GOODS)

Returns must be pre-authorized (if not pre-authorized the return will be rejected). Goods may only be returned direct to us if they were purchased direct from us (customer must prove if necessary). Otherwise to be returned to original vendor. Goods must be in re-sellable condition, in the opinion of R&G Racing. All returns are subject to a 25% restocking and handling fee (25% of the gross value exc. P&P – at the prevailing price at time of purchase). The customer must pay any and all carriage charges. No returns of discontinued products, unless within 14 days of

purchase. This policy does not affect your statutory rights and does not refer to faulty goods. NOTICE DE MONTAGE POUR FP0288 PROTECTIONS FOURCHE





CE KIT CONTIENT LES ARTICLES ILLUSTRÉS ET ÉTIQUETES SUR LA PAGE.

CERTAINES PARTIES PEUVENT ÊTRE PRÉSENTES UNIQUEMENT POUR LA CLARTÉ DES INSTRUCTIONS.

NE PAS PROCÉDER AU MONTAGE TANT QUE VOUS N'ÊTES PAS SÛR QUE TOUTES LES PIÈCES SOIENT PRÉSENTES.

VEUILLEZ LIRE TOUTES LES INSTRUCTIONS AVANT DE CONTINUER.

EN CAS DE DOUTE LORS DU MONTAGE DE NOS PRODUITS, CONSULTEZ UN DE NOS REVENEURS OU FAITES APPEL A UN TECHNICIEN QUALIFIÉ.

VEUILLEZ NOTER QUE LA FAÇON DONT LE KIT EST EMBALLÉ NE REPRÉSENTE PAS NECESSAIREMENT LA MANIÈRE DE LE MONTER SUR LA MOTO.

SI DES RONDELLES EN CAOUTCHOUC SONT UTILISÉES POUR MAINTENIR LES COMPOSANTS SUR LES BOULONS, ELLES PEUVENT ÊTRE JETÉES.

NOTICE DISPONIBLE AU TÉLÉCHARGEMENT SUR :

WWW.RG-RACING.COM

<u>OUTILS REQUIS</u>	<u>VALEURS DE SERRAGE</u>
<ul style="list-style-type: none"> • CLÉ À CLIQUET + DOUILLES 13mm x2 	M4 BOULON = 8Nm M5 BOULON = 12Nm M6 BOULON = 15Nm M8 BOULON = 20Nm M10 BOULON = 40Nm M12 BOULON = 40Nm

LÉGENDE

R&G Racing

Unit 1, Shelley's Lane, East Worldham, Alton, Hampshire, GU34 3AQ

Tel: +44 (0)1420 89007 Fax: +44 (0)1420 87301 www.rg-racing.com Email: info@rg-racing.com



ARTICLE NO.	DESCRIPTION	QTÉ
ARTICLE 1	PROTECTION : B0442 M8	2
ARTICLE 2	ENTRETOISE GAUCHE : S1312	1
ARTICLE 3	ENTRETOISE DROITE : S1313	1
ARTICLE 4	M8 x 1.25 ÉCROUS	2
ARTICLE 5	M8 RONDELLE (19mm O/D)	2
ARTICLE 6	AXE : SB140 (M8 x 320mm DE LONG)	1

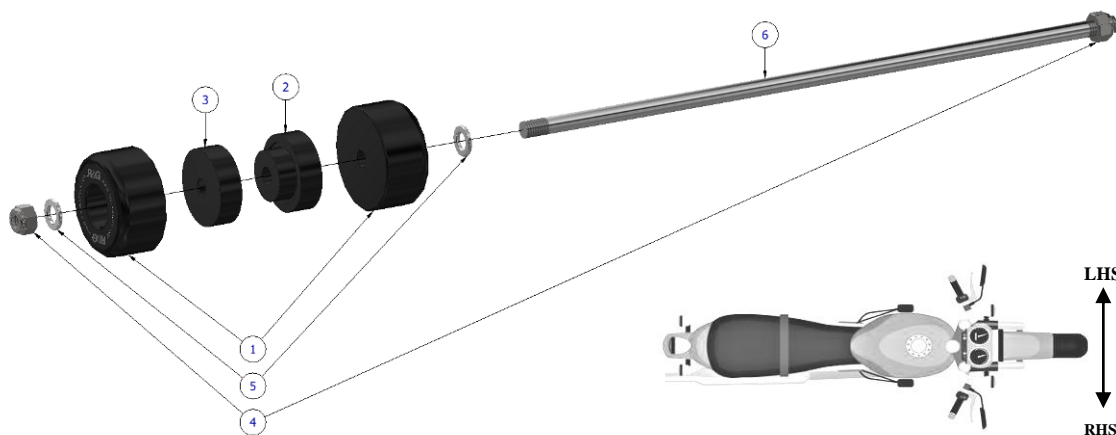

NOTICE DE MONTAGE

- Serrez à la main 1x écrou Nyloc M8 (Article 4) à une extrémité de l'axe (Article 6).
- Maintenez l'axe verticalement avec l'écrou à l'extrémité inférieure de l'axe.
- Faites glisser 1x rondelle M8 (Article 5) le long de l'axe, suivie de 1x protection (Article 1) et de l'entretoise côté gauche (Article 2) dans l'orientation indiquée ci-dessus.
- Faites glisser l'ensemble à travers le côté gauche (gauche) de l'axe de roue avant en vous assurant que l'entretoise s'insère parfaitement dans l'axe..
- Insérez l'entretoise droite (Article 3) sur la partie droite dépassant de l'axe, suivie de la protection restante, de la rondelle M8 et de l'écrou Nyloc.
- Serrez uniformément les écrous de chaque côté de l'axe jusqu'à ce que le Nyloc soit engagé aux deux extrémités et que les protections ne tournent plus librement (mais peuvent toujours être tournées à la main).

Note: Ne serrez pas trop et assurez-vous qu'une quantité similaire de fil dépasse des écrous de chaque côté de l'axe.

(Ceci est plus facilement réalisable en appliquant une petite quantité de frein-filet ou de super glue sur l'un des écrous lorsque 3 mm de filetage dépassent de la face extérieure).





ISSUE 1 - 29/02/2024 (MH)

CONSUMER NOTICE

The catalogue description and any exhibition of samples are only broad indications of the Products and R&G may make design changes which do not diminish their performance or visual appeal and supplying them in such state shall conform to the order. The Buyer acknowledges no representation or warranty (other than as to title) has been given or will apply to the Products other than those in R&G's order or confirmation and the Buyer confirms it has chosen the Products as being of merchantable quality and suitable for its particular purposes. Where R&G fits the Products or undertakes other services it shall exercise reasonable skill and care and rectify any fault free of charge unless the workmanship has been disturbed. The Buyer is responsible for ensuring that the warranty on the motorcycle is not affected by the fitting of the Products. On return of any defective Products R&G shall at its option either supply a replacement or refund the purchase money but shall not be liable if the Products have been modified or used or maintained otherwise than in accordance with R&G's or manufacturer's instructions and good engineering practice or if the defect arises from accident or neglect. Other than identified above and subject to R&G not limiting its liability for causing death and personal injury, it shall not be liable for indirect or consequential loss and otherwise its liability shall be limited to the amounts paid by the Buyer for the Products or the fitting or service concerned. These terms do not affect the Buyer's statutory rights.

R&G RACING RETURNS POLICY (NON-FAULTY GOODS)

Returns must be pre-authorized (if not pre-authorized the return will be rejected). Goods may only be returned direct to us if they were purchased direct from us (customer must prove if necessary). Otherwise to be returned to original vendor. Goods must be in re-sellable condition, in the opinion of R&G Racing. All returns are subject to a 25% restocking and handling fee (25% of the gross value exc. P&P – at the prevailing price at time of purchase). The customer must pay any and all carriage charges. No returns of discontinued products, unless within 14 days of purchase. This policy does not affect your statutory rights and does not refer to faulty goods.

R&G Racing

Unit 1, Shelley's Lane, East Worldham, Alton, Hampshire, GU34 3AQ

Tel: +44 (0)1420 89007 Fax: +44 (0)1420 87301 www.rg-racing.com Email: info@rg-racing.com