



**FITTING INSTRUCTIONS FOR EH0076BK EXHAUST HANGER**  
**BMW S1000R 2017-**



**THIS KIT CONTAINS THE ITEMS PICTURED AND LABELLED BELOW.**  
**DO NOT PROCEED UNTIL YOU ARE SURE ALL PARTS ARE PRESENT.**

Please note that the way the kit is packed does not necessarily represent the way of mounting to the bike.

THE PARTS SHOWN MAY BE REPRESENTATIVE ONLY (FOR CLARITY OF INSTRUCTIONS ONLY)

**LEGEND**

ITEM 1 = EXHAUST HANGER (HB0076) (x1).  
ITEM 2 = M8 x 25mm LONG BUTTON HEAD BOLTS (x3).  
ITEM 3 = M8 WASHER (x1).

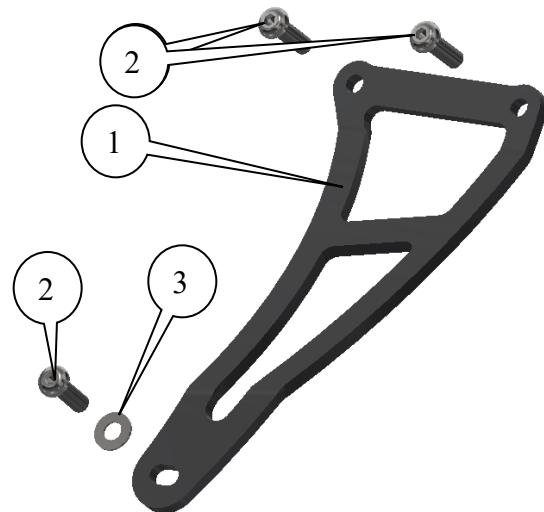

**TOOLS REQUIRED**

- Set of metric Allen keys to include 5 & 6mm A/F sizes.
- Socket set to include 12mm socket & wrench.

Please note that in cases where kits are packed with rubber washers holding the components onto the bolt – *the rubber washers should be thrown away!*

**FITTING INSTRUCTIONS**

- To fit the R&G Exhaust Hanger the OEM pillion footrest mounting bracket needs to be removed.

Racing Technique Ltd T/A R&G  
Unit 1, Shelley's Lane, East Worldham, Alton, Hampshire, GU34 3AQ  
Tel: +44 (0)1420 89007 Fax: +44 (0)1420 87301 [www.rg-racing.com](http://www.rg-racing.com) Email: [info@rg-racing.com](mailto:info@rg-racing.com)



- Place two the button head bolts (item 2) through the top holes in the exhaust hanger (item 1).
- Offer the R&G exhaust hanger place into position and tighten into the thread on the sub-frame, as shown above.
- Place the remaining button head bolt (item 2) with the washer (item 3) through the lower hole in the exhaust hanger and into the exhaust mounting bracket and secure as original.
- Ensure the exhaust hanger is correctly fitted before tightening all three bolts.
- Please ensure when the motorcycle is being used that no parts are in such a position that they may collide/damage other bike parts (this is particularly important if using after-market cans or exhaust systems).

***Please note that it is your responsibility to ensure that no part of the exhaust hanger or exhaust assembly fouls or comes into contact with other parts of the machine. Do not ride the motorcycle until this aspect has been verified and you have compressed the rear suspension (if appropriate to the design of the motorcycle) to test this thoroughly.***

ISSUE 1 27/07/2017 (NSY)

#### CONSUMER NOTICE

The catalogue description and any exhibition of samples are only broad indications of the Products and R&G may make design changes which do not diminish their performance or visual appeal and supplying them in such state shall conform to the order. The Buyer acknowledges no representation or warranty (other than as to title) has been given or will apply to the Products other than those in R&G's order or confirmation and the Buyer confirms it has chosen the Products as being of merchantable quality and suitable for its particular purposes. Where R&G fits the Products or undertakes other services it shall exercise reasonable skill and care and rectify any fault free of charge unless the workmanship has been disturbed. The Buyer is responsible for ensuring that the warranty on the motorcycle is not affected by the fitting of the Products. On return of any defective Products R&G shall at its option either supply a replacement or refund the purchase money but shall not be liable if the Products have been modified or used or maintained otherwise than in accordance with R&G's or manufacturer's instructions and good engineering practice or if the defect arises from accident or neglect. Other than identified above and subject to R&G not limiting its liability for causing death and personal injury, it shall not be liable for indirect or consequential loss and otherwise its liability shall be limited to the amounts paid by the Buyer for the Products or the fitting or service concerned. These terms do not affect the Buyer's statutory rights.

#### R&G RACING RETURNS POLICY (NON-FAULTY GOODS)

Returns must be pre-authorised (if not pre-authorised the return will be rejected). Goods may only be returned direct to us if they were purchased direct from us (customer must prove if necessary). Otherwise to be returned to original vendor. Goods must be in re-sellable condition, in the opinion of R&G Racing. All returns are subject to a 25% restocking and handling fee (25% of the gross value exc. P&P – at the prevailing price at time of purchase). The customer must pay any and all carriage charges. No returns of discontinued products, unless within 14 days of purchase. This policy does not affect your statutory rights and does not refer to faulty goods.



**NOTICE DE MONTAGE POUR EH0076BK SUPPORT POT D'ÉCHAPPEMENT**  
**BMW S1000R 2017-**



**Le kit contient les articles exposés ci-dessous, vérifier que toutes les pièces soient présentes avant de procéder au montage.**

**La façon dont le kit est emballé ne correspond pas forcément à la façon de monter les pièces sur la moto.**

**LES PARTIES PRESENTÉES PEUVENT ÊTRE UNIQUEMENT REPRESENTATIVES (POUR LA CLARTE DES INSTRUCTIONS UNIQUEMENT)**

**LÉGENDE**

ARTICLE 1 = SUPPORT D'ÉCHAPPEMENT (HB0076) (x1).

ARTICLE 2 = M8 x 25mm BOULONS (x3).

ARTICLE 3 = M8 RONDELLE (x1).

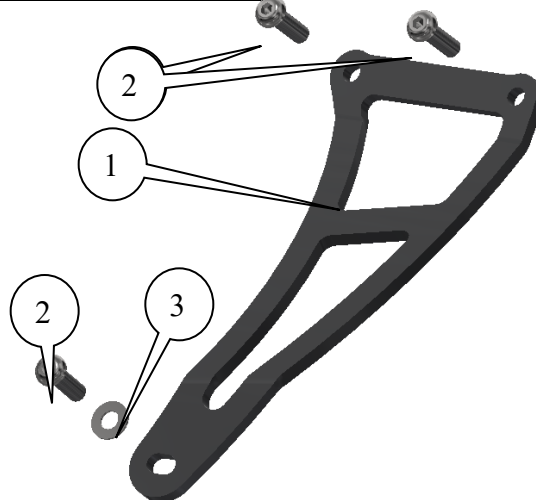

**OUTILS REQUIS**

- Clés Allen 5 & 6mm.
- Clé à cliquet + douille 12mm

Notez que si les kits sont emballés avec des rondelles en caoutchouc servant à tenir les composants, *ces rondelles doivent être jetées !*



## **NOTICE DE MONTAGE**

- Pour monter le support d'échappement R&G, le support de fixation du repose pied passager doit être enlevé.
- Insérer 2 boulons (article 2) dans les trous supérieurs du support d'échappement (article 1).
- Monter le support d'échappement R&G en position puis serrer dans le filetage du sous-cadre, voir ci-dessus.
- Insérer le boulon restant (article 2) avec la rondelle (article 3) dans le trou inférieur du support d'échappement dans le support de fixation d'échappement puis fixer comme à l'origine.
- Veiller à ce que le support d'échappement soit correctement monté avant de serrer les 3 boulons.
- Vérifier qu'aucune partie de la moto ne puisse potentiellement heurter une autre partie de la moto lors de son utilisation (cela est particulièrement important si vous utilisez un pot d'échappement qui n'est pas d'origine).

***Il est de votre responsabilité de veiller à ce qu'aucune partie du support de pot d'échappement ne puisse entrer en contact avec d'autres parties de la moto. Ne pas utiliser la moto tant que ce point n'a pas été vérifié, en ayant compresser l'amortisseur arrière (si le design de la moto le permet).***

ISSUE 1 27/07/2017 (NSY)

## **CONSUMER NOTICE**

The catalogue description and any exhibition of samples are only broad indications of the Products and R&G may make design changes which do not diminish their performance or visual appeal and supplying them in such state shall conform to the order. The Buyer acknowledges no representation or warranty (other than as to title) has been given or will apply to the Products other than those in R&G's order or confirmation and the Buyer confirms it has chosen the Products as being of merchantable quality and suitable for its particular purposes. Where R&G fits the Products or undertakes other services it shall exercise reasonable skill and care and rectify any fault free of charge unless the workmanship has been disturbed. The Buyer is responsible for ensuring that the warranty on the motorcycle is not affected by the fitting of the Products. On return of any defective Products R&G shall at its option either supply a replacement or refund the purchase money but shall not be liable if the Products have been modified or used or maintained otherwise than in accordance with R&G's or manufacturer's instructions and good engineering practice or if the defect arises from accident or neglect. Other than identified above and subject to R&G not limiting its liability for causing death and personal injury, it shall not be liable for indirect or consequential loss and otherwise its liability shall be limited to the amounts paid by the Buyer for the Products or the fitting or service concerned. These terms do not affect the Buyer's statutory rights.

## **R&G RACING RETURNS POLICY (NON-FAULTY GOODS)**

Returns must be pre-authorised (if not pre-authorised the return will be rejected). Goods may only be returned direct to us if they were purchased direct from us (customer must prove if necessary). Otherwise to be returned to original vendor. Goods must be in re-sellable condition, in the opinion of R&G Racing. All returns are subject to a 25% restocking and handling fee (25% of the gross value exc. P&P – at the prevailing price at time of purchase). The customer must pay any and all carriage charges. No returns of discontinued products, unless within 14 days of purchase. This policy does not affect your statutory rights and does not refer to faulty goods.



**FITTING INSTRUCTIONS FOR BLP0002BK REAR FOOTREST BLANKING**  
**PLATE**  
**BMW S1000RR 2010 RIGHT AND LEFT HAND SIDES**



**THIS KIT CONTAINS THE ITEMS PICTURED AND LABELLED BELOW.**  
**DO NOT PROCEED UNTIL YOU ARE SURE ALL PARTS ARE PRESENT.**

**Please note that the way the kit is packed does not necessarily represent the way of mounting to the bike**

THE PARTS SHOWN MAY BE REPRESENTATIVE ONLY (FOR CLARITY OF INSTRUCTIONS ONLY)

M8x20mm LONG  
COUNTER-SUNK  
BOLT (x1)

M8x20mm LONG  
COUNTER-SUNK  
BOLT (x1)

**LEFT HAND**  
**SIDE**



BLANKING-PLATE  
(BLP0002) (x1)



M8x20mm LONG  
COUNTER-SUNK  
BOLT (x1)

M8x20mm LONG  
COUNTER-SUNK  
BOLT (x1)

### **RIGHT HAND SIDE**



BLANKING-PLATE  
(BLP0002) (x1)

### **ADDITIONAL PARTS**

You will also receive 4x spacers (S0379)

Please note that in cases where kits are packed with rubber washers holding the components onto the bolt –  
*the rubber washers should be thrown away!*

### **TOOLS REQUIRED**

- 5mm metric Allen key.
- T45 Torx key.

### **Left-hand side (as you sit on bike)**

- Using T45 Torx key remove the two bolts and remove rear footrest.
- Fit two of the counter sunk headed bolts through the blanking plate so head sits in counter-sink.
- Offer assembly up to bike and engage both bolts (depending on the size of the weld you may need to use the spacers from kit between the blanking plate and the frame).
- Tighten evenly using 5mm Allen key.

### **Right-hand side (as you sit on bike)**

- Using T45 Torx key remove the two bolts and remove rear footrest.
- Fit two of the counter sunk headed bolts through the blanking plate so head sits in counter-sink.
- Offer assembly up to bike and engage both bolts (depending on the size of the weld you may need to use the spacers from kit between the blanking plate and the frame).
- Tighten evenly using 5mm Allen key.





#### **CONSUMER NOTICE**

The catalogue description and any exhibition of samples are only broad indications of the Products and R&G may make design changes which do not diminish their performance or visual appeal and supplying them in such state shall conform to the order. The Buyer acknowledges no representation or warranty (other than as to title) has been given or will apply to the Products other than those in R&G's order or confirmation and the Buyer confirms it has chosen the Products as being of merchantable quality and suitable for its particular purposes. Where R&G fits the Products or undertakes other services it shall exercise reasonable skill and care and rectify any fault free of charge unless the workmanship has been disturbed. The Buyer is responsible for ensuring that the warranty on the motorcycle is not affected by the fitting of the Products. On return of any defective Products R&G shall at its option either supply a replacement or refund the purchase money but shall not be liable if the Products have been modified or used or maintained otherwise than in accordance with R&G's or manufacturer's instructions and good engineering practice or if the defect arises from accident or neglect. Other than identified above and subject to R&G not limiting its liability for causing death and personal injury, it shall not be liable for indirect or consequential loss and otherwise its liability shall be limited to the amounts paid by the Buyer for the Products or the fitting or service concerned. These terms do not affect the Buyer's statutory rights.

#### **R&G RACING RETURNS POLICY (NON-FAULTY GOODS)**

Returns must be pre-authorised (if not pre-authorised the return will be rejected). Goods may only be returned direct to us if they were purchased direct from us (customer must prove if necessary). Otherwise to be returned to original vendor. Goods must be in re-sellable condition, in the opinion of R&G Racing. All returns are subject to a 25% restocking and handling fee (25% of the gross value exc. P&P – at the prevailing price at time of purchase). The customer must pay any and all carriage charges. No returns of discontinued products, unless within 14 days of purchase. This policy does not affect your statutory rights and does not refer to faulty goods.