



**FITTING INSTRUCTIONS FOR EH0027 EXHAUST HANGER**



**THIS KIT CONTAINS THE ITEMS PICTURED AND LABELLED OVER PAGE.**

DO NOT PROCEED UNTIL YOU ARE SURE ALL PARTS ARE PRESENT.

PLEASE READ ALL INSTRUCTIONS BEFORE PRECEEDING.

**IF IN ANY DOUBT WHEN FITTING OUR PRODUCTS, CONSULT ONE OF OUR DEALERS  
OR HAVE FITTED BY A QUALIFIED TECHNICIAN.**

PLEASE NOTE THAT THE WAY THE KIT IS PACKED DOES NOT NECESSARILY REPRESENT THE WAY OF  
MOUNTING TO THE BIKE.

THE PARTS SHOWN MAY BE REPRESENTATIVE ONLY (FOR CLARITY OF INSTRUCTIONS ONLY).

IN THE EVENT OF RUBBER WASHERS BEING USED TO HOLD COMPONENTS ONTO BOLTS,  
THESE RUBBER WASHERS CAN BE THROWN AWAY.

**Digital copies of these instructions are available to download from**  
[www.rg-racing.com](http://www.rg-racing.com)



<b><u>TOOLS REQUIRED</u></b>	<b><u>GENERAL TORQUE SETTINGS</u></b>
<ul style="list-style-type: none"> <li>METRIC ALLEN TOOL SET</li> <li>METRIC SOCKET SET</li> </ul>	M4 BOLT = 8Nm M5 BOLT = 12Nm M6 BOLT = 15Nm M8 BOLT = 20Nm M10 BOLT = 40Nm M12 BOLT = 40Nm

### **LEGEND**

<b>ITEM No</b>	<b>DESCRIPTION</b>	<b>QTY</b>
ITEM 1	EXHAUST HANGER LHS (EH0027 L)	1
ITEM 2	EXHAUST HANGER RHS (EH0027 R)	1
ITEM 3	M8 x 20mm BOLT	4
ITEM 4	M8 x 25mm BOLT	2
ITEM 5	M8 WASHER	4
ITEM 6	M8 NUT	2

### **ASSEMBLY PICTURE**

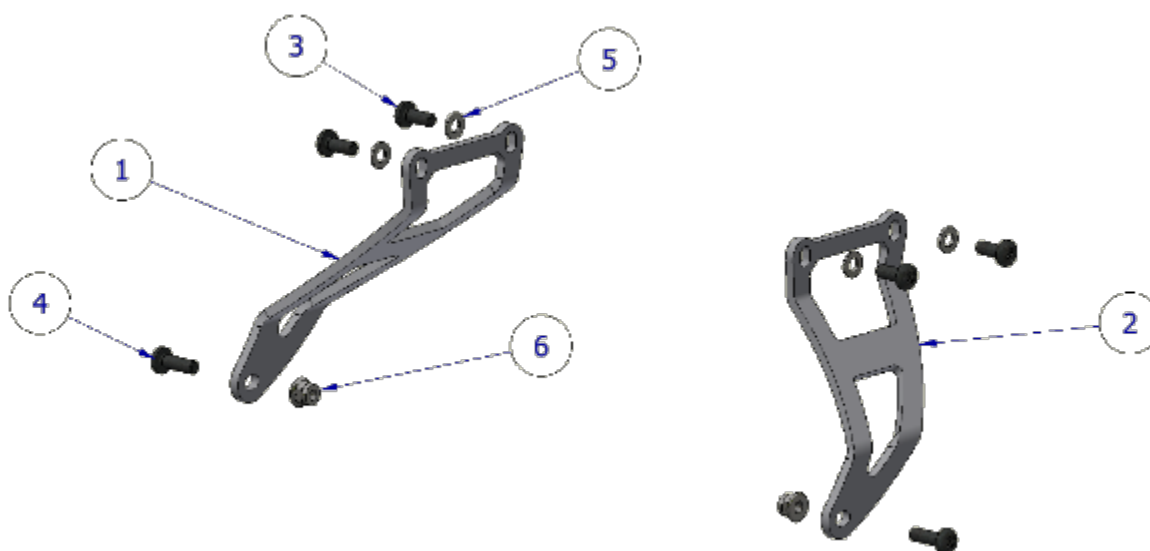

R&G Racing

Unit 1, Shelley's Lane, East Worldham, Alton, Hampshire, GU34 3AQ

Tel: +44 (0)1420 89007 Fax: +44 (0)1420 87301 [www.rg-racing.com](http://www.rg-racing.com) Email: [info@rg-racing.com](mailto:info@rg-racing.com)



## **FITTING INSTRUCTIONS**

- To fit the R&G Exhaust Hanger, the OEM pillion footrest/exhaust brackets needs to be removed.
- Remove the OEM bolt through from the bracket on the top of the exhaust silencer, taking note of the orientation of the fixings.
- Take the LHS R&G Exhaust Hanger (**Item 1**) and offer it up to the exhaust silencer bracket.
- Offer the exhaust bracket into position and engage 2x M8 x 20mm bolts (**Item 3**) & washers (**Item 5**) into the pillion foot peg mounting holes (do not fully tighten at this stage).
- Engage 1x M8 x 25mm bolts (**Item 4**) through the bottom of the bracket and exhaust mount and into one of the M8 nuts (**Item 6**) (do not fully tighten at this stage).
- Ensure the exhaust hanger is correctly fitted before tightening all three bolts.
- Repeat all steps above for the RHS of the bike in the same order.
- Please ensure when the motorcycle is being used that no parts are in such a position that they may collide/damage other bike parts (this is particularly important if using after-market cans or exhaust systems).

***Please note that it is your responsibility to ensure that no part of the exhaust hanger or exhaust assembly fouls or comes into contact with other parts of the machine. Do not ride the motorcycle until this aspect has been verified and you have compressed the rear suspension (if appropriate to the design of the motorcycle) to test this thoroughly.***

**See more R&G products for your Motorcycle in the link below:**

[R&G Racing | All Products for Suzuki - SV1000 FullFaired \(2007\) \(rg-racing.com\)](http://www.rg-racing.com)

ISSUE 1 – 04/01/2023 - (MH)

### **CONSUMER NOTICE**

The catalogue description and any exhibition of samples are only broad indications of the Products and R&G may make design changes which do not diminish their performance or visual appeal and supplying them in such state shall conform to the order. The Buyer acknowledges no representation or warranty (other than as to title) has been given or will apply to the Products other than those in R&G's order or confirmation and the Buyer confirms it has chosen the Products as being of merchantable quality and suitable for its particular purposes. Where R&G fits the Products or undertakes other services it shall exercise reasonable skill and care and rectify any fault free of charge unless the workmanship has been disturbed. The Buyer is responsible for ensuring that the warranty on the motorcycle is not affected by the fitting of the Products. On return of any defective Products R&G shall at its option either supply a replacement or refund the purchase money but shall not be liable if the Products have been modified or used or maintained otherwise than in accordance with R&G's or manufacturer's instructions and good engineering practice or if the defect arises from accident or neglect. Other than identified above and subject to R&G not limiting its liability for causing death and personal injury, it shall not be liable for indirect or consequential loss and otherwise its liability shall be limited to the amounts paid by the Buyer for the Products or the fitting or service concerned. These terms do not affect the Buyer's statutory rights.

### **R&G RETURNS POLICY (NON-FAULTY GOODS)**

Returns must be pre-authorized (if not pre-authorized the return will be rejected). Goods may only be returned direct to us if they were purchased direct from us (customer must prove if necessary). Otherwise to be returned to original vendor. Goods must be in re-sellable condition, in the opinion of R&G. All returns are subject to a 25% restocking and handling fee (25% of the gross value exc. P&P – at the prevailing price at time of purchase). The customer must pay any and all carriage charges. No returns of discontinued products, unless within 14 days of purchase. This policy does not affect your statutory rights and does not refer to faulty goods.

R&G Racing

Unit 1, Shelley's Lane, East Worldham, Alton, Hampshire, GU34 3AQ

Tel: +44 (0)1420 89007 Fax: +44 (0)1420 87301 [www.rg-racing.com](http://www.rg-racing.com) Email: [info@rg-racing.com](mailto:info@rg-racing.com)



**NOTICE DE MONTAGE POUR EH0027 SUPPORT D'ÉCHAPPEMENT**



**CE KIT CONTIENT LES ARTICLES ILLUSTRÉS ET ÉTIQUETES SUR LA PAGE.**

CERTAINES PARTIES PEUVENT ÊTRE PRÉSENTES UNIQUEMENT POUR LA CLARTE DES INSTRUCTIONS.

NE PAS PROCÉDER AU MONTAGE TANT QUE VOUS N'ÊTES PAS SÛR QUE TOUTES LES PIÈCES SOIENT PRÉSENTES.

**VEUILLEZ LIRE TOUTES LES INSTRUCTIONS AVANT DE CONTINUER.**

**EN CAS DE DOUTE LORS DU MONTAGE DE NOS PRODUITS, CONSULTEZ UN DE NOS REVENDEURS OU FAITES APPEL À UN TECHNICIEN QUALIFIÉ.**

VEUILLEZ NOTER QUE LA FAÇON DONT LE KIT EST EMBALLÉ NE REPRÉSENTE PAS NECESSAIREMENT LA MANIÈRE DE LE MONTER SUR LA MOTO.

SI DES RONDELLES EN CAOUTCHOUC SONT UTILISÉES POUR MAINTENIR LES COMPOSANTS SUR LES BOULONS, ELLES PEUVENT ÊTRE JETÉES.

**NOTICE DISPONIBLE AU TÉLÉCHARGEMENT SUR :**  
[WWW.RG-RACING.COM](http://WWW.RG-RACING.COM)



<b><u>OUTILS REQUIS</u></b>	<b><u>VALEURS DE SERRAGE</u></b>
<ul style="list-style-type: none"> <li>• CLÉ ALLEN</li> <li>• CLÉ MÉTRIQUE</li> </ul>	<ul style="list-style-type: none"> <li>• M4 BOULON = 8Nm</li> <li>• M5 BOULON = 12Nm</li> <li>• M6 BOULON = 15Nm</li> <li>• M8 BOULON = 20Nm</li> <li>• M10 BOULON = 40Nm</li> <li>• M12 BOULON = 40Nm</li> </ul>

### **LÉGENDE**

<b>ARTICLE No</b>	<b>DESCRIPTION</b>	<b>QTÉ</b>
ARTICLE 1	SUPPORT D'ÉCHAPPEMENT CÔTÉ GAUCHE (EH0027 L)	1
ARTICLE 2	SUPPORT D'ÉCHAPPEMENT CÔTÉ DROIT (EH0027 R)	1
ARTICLE 3	M8 x 20mm BOULON	4
ARTICLE 4	M8 x 25mm BOULON	2
ARTICLE 5	M8 RONDELLE	4
ARTICLE 6	M8 ÉCROU	2

### **SCHÉMA D'ENSEMBLE**

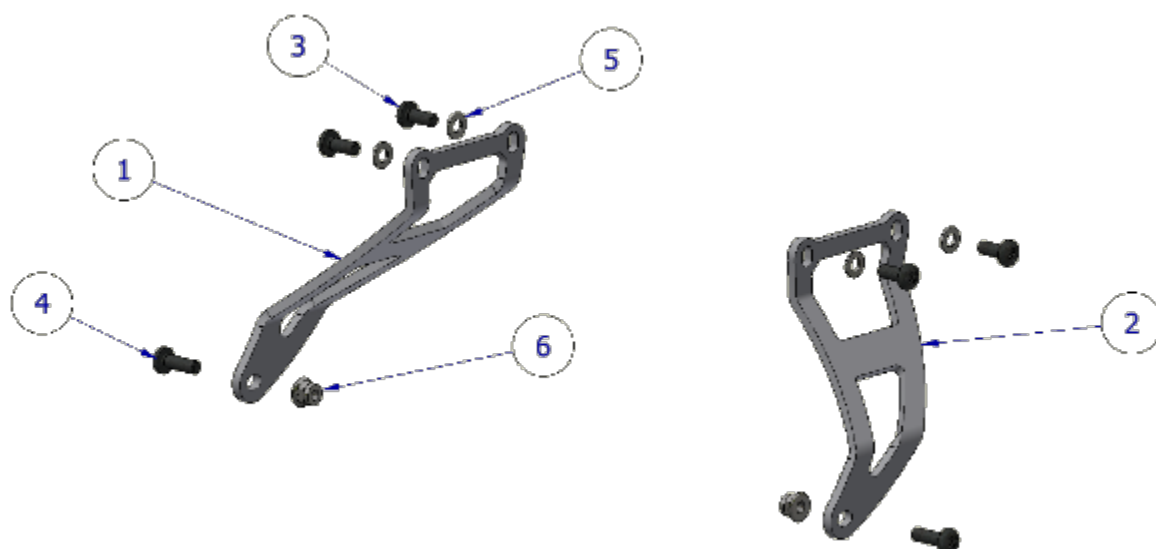

R&G Racing

Unit 1, Shelley's Lane, East Worldham, Alton, Hampshire, GU34 3AQ

Tel: +44 (0)1420 89007 Fax: +44 (0)1420 87301 [www.rg-racing.com](http://www.rg-racing.com) Email: [info@rg-racing.com](mailto:info@rg-racing.com)



## **NOTICE DE MONTAGE**

- Pour installer le support d'échappement R&G, les supports de repose-pieds/échappement d'origine doivent être retirés.
- Retirez le boulon d'origine à travers du support sur le dessus du silencieux d'échappement, en prenant note de l'orientation des fixations.
- Prenez le support d'échappement R&G côté gauche (article 1) et placez-le sur le support du silencieux d'échappement.
- Mettez le support d'échappement en place et engagez 2 boulons M8 x 20 mm (article 3) et rondelles (article 5) dans les trous de montage du repose-pied du passager (ne serrez pas complètement à ce stade).
- Engagez 1 boulon M8 x 25 mm (article 4) dans le bas du support et du support d'échappement et dans l'un des écrous M8 (article 6) (ne serrez pas complètement à ce stade).
- Assurez-vous que le support d'échappement soit correctement installé avant de serrer les trois boulons.
- Répétez toutes les étapes ci-dessus du côté droit de la moto dans le même ordre.
- Veuillez-vous assurer, lorsque la moto est utilisée, qu'aucune pièce ne se trouve dans une position telle qu'elle puisse entrer en collision/endommager d'autres pièces de la moto (ceci est particulièrement important si vous utilisez des embouts ou systèmes d'échappement non d'origine).

***Veuillez noter qu'il est de votre responsabilité de vous assurer qu'aucune partie du support d'échappement ou de l'ensemble d'échappement n'entre en contact avec d'autres pièces de la machine. Ne conduisez pas la moto tant que cet aspect n'a pas été vérifié et que vous n'avez pas comprimé la suspension arrière (si cela convient à la conception de la moto) pour le tester à fond.***

**Voir plus de produits R&G pour votre moto via ce lien :**

[R&G Racing | All Products for Suzuki - SV1000 FullFaired \(2007\) \(rg-racing.com\)](http://www.rg-racing.com)

ISSUE 1 - 04/01/2023 - (MH)

### **CONSUMER NOTICE**

The catalogue description and any exhibition of samples are only broad indications of the Products and R&G may make design changes which do not diminish their performance or visual appeal and supplying them in such state shall conform to the order. The Buyer acknowledges no representation or warranty (other than as to title) has been given or will apply to the Products other than those in R&G's order or confirmation and the Buyer confirms it has chosen the Products as being of merchantable quality and suitable for its particular purposes. Where R&G fits the Products or undertakes other services it shall exercise reasonable skill and care and rectify any fault free of charge unless the workmanship has been disturbed. The Buyer is responsible for ensuring that the warranty on the motorcycle is not affected by the fitting of the Products. On return of any defective Products R&G shall at its option either supply a replacement or refund the purchase money but shall not be liable if the Products have been modified or used or maintained otherwise than in accordance with R&G's or manufacturer's instructions and good engineering practice or if the defect arises from accident or neglect. Other than identified above and subject to R&G not limiting its liability for causing death

R&G Racing

Unit 1, Shelley's Lane, East Worldham, Alton, Hampshire, GU34 3AQ

Tel: +44 (0)1420 89007 Fax: +44 (0)1420 87301 [www.rg-racing.com](http://www.rg-racing.com) Email: [info@rg-racing.com](mailto:info@rg-racing.com)



and personal injury, it shall not be liable for indirect or consequential loss and otherwise its liability shall be limited to the amounts paid by the Buyer for the Products or the fitting or service concerned. These terms do not affect the Buyer's statutory rights.

**R&G RETURNS POLICY (NON-FAULTY GOODS)**

Returns must be pre-authorized (if not pre-authorized the return will be rejected). Goods may only be returned direct to us if they were purchased direct from us (customer must prove if necessary). Otherwise to be returned to original vendor. Goods must be in re-sellable condition, in the opinion of R&G. All returns are subject to a 25% restocking and handling fee (25% of the gross value exc. P&P – at the prevailing price at time of purchase). The customer must pay any and all carriage charges. No returns of discontinued products, unless within 14 days of purchase. This policy does not affect your statutory rights and does not refer to faulty goods.

R&G Racing

Unit 1, Shelley's Lane, East Worldham, Alton, Hampshire, GU34 3AQ

Tel: +44 (0)1420 89007 Fax: +44 (0)1420 87301 [www.rg-racing.com](http://www.rg-racing.com) Email: [info@rg-racing.com](mailto:info@rg-racing.com)