

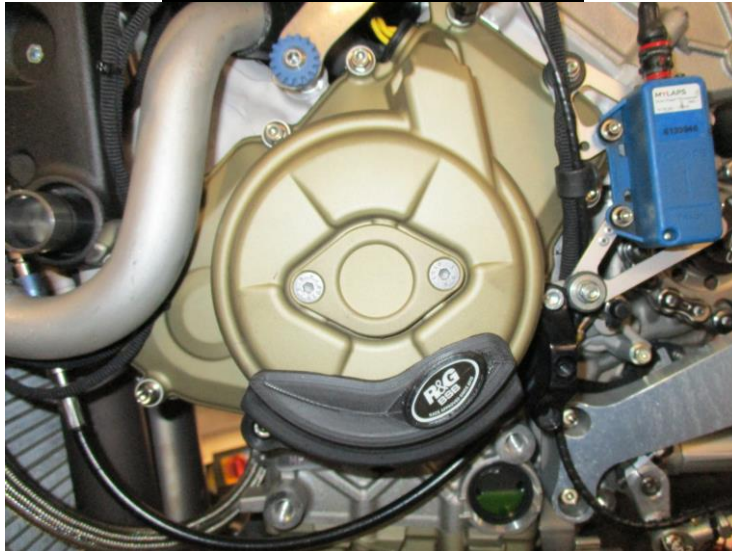

**FITTING INSTRUCTIONS FOR ECS0148 ENGINE CASE SLIDER  
FOR DUCATI V4 2018-**



**THIS KIT CONTAINS THE ITEMS PICTURED AND LABELLED OVER PAGE.**

SOME PARTS MAY BE SHOWN FOR CLARITY OF INSTRUCTIONS ONLY.

DO NOT PROCEED UNTIL YOU ARE SURE ALL PARTS ARE PRESENT.

**PLEASE READ ALL INSTRUCTIONS BEFORE PROCEEDING.**

**IF IN ANY DOUBT WHEN FITTING OUR PRODUCTS, CONSULT ONE OF  
OUR DEALERS OR HAVE FITTED BY A QUALIFIED TECHNICIAN.**

PLEASE NOTE THAT THE WAY THE KIT IS PACKED DOES NOT NECESSARILY REPRESENT THE  
WAY OF MOUNTING TO THE BIKE.

IN THE EVENT OF RUBBER WASHERS BEING USED TO HOLD COMPONENTS ONTO BOLTS,  
THESE RUBBER WASHERS CAN BE THROWN AWAY.

**DIGITAL COPIES OF THESE INSTRUCTIONS ARE AVAILABLE FROM:**

[WWW.RG-RACING.COM](http://WWW.RG-RACING.COM)



<u>TOOLS REQUIRED</u>	<u>GENERAL TORQUE SETTINGS</u>
<ul style="list-style-type: none"> <li>• Set of metric Allen keys.</li> <li>• Set of Torx bits or keys.</li> </ul>	<p>M4 BOLT = 8Nm</p> <p>M5 BOLT = 12Nm</p> <p>M6 BOLT = 15Nm</p> <p>M8 BOLT = 20Nm</p> <p>M10 BOLT = 40Nm</p> <p>M12 BOLT = 40Nm</p>

ITEM NO.	DESCRIPTION	QTY
ITEM 1	ENGINE CASE SLIDER (ECS0148)	1
ITEM 2	M6 x 40mm LONG CAP HEAD BOLTS	3
ITEM 3	M6 WASHERS	3

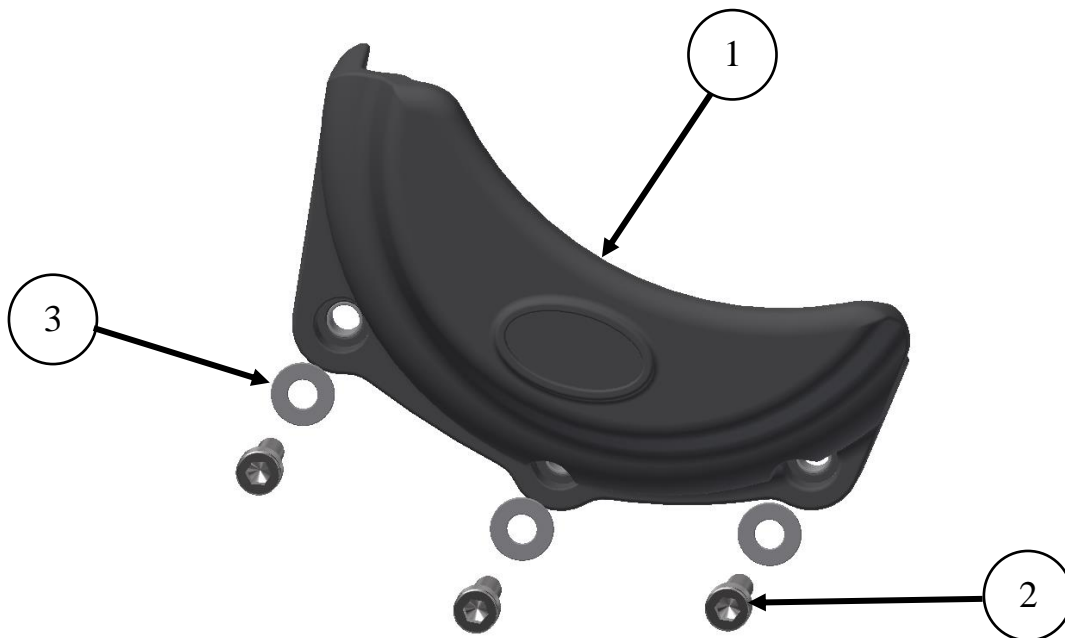

**Assembly Diagram**

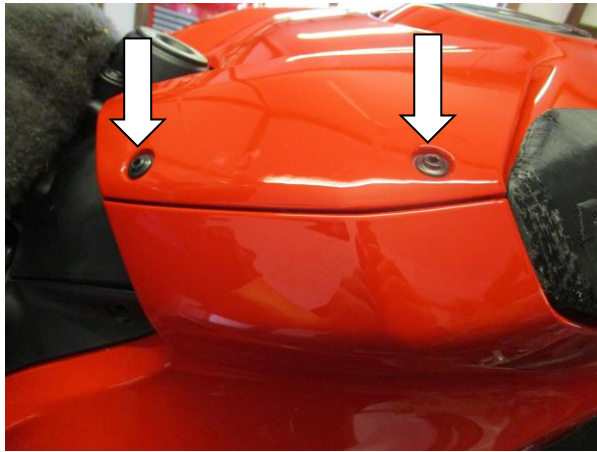

Picture 1

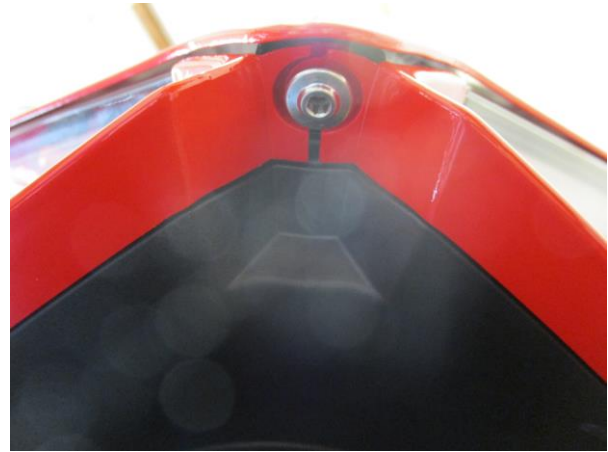

Picture 2



Picture 3

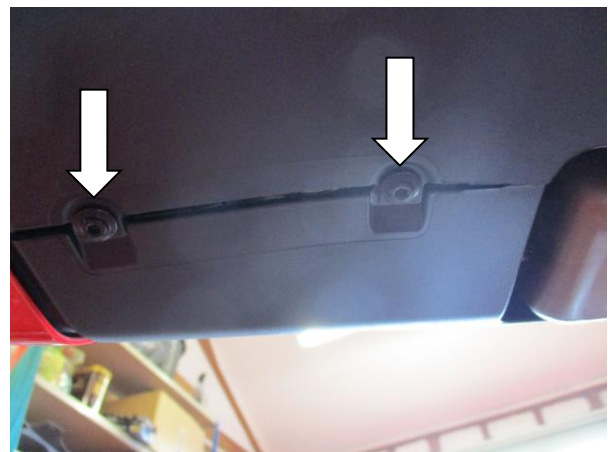

Picture 4



Picture 5

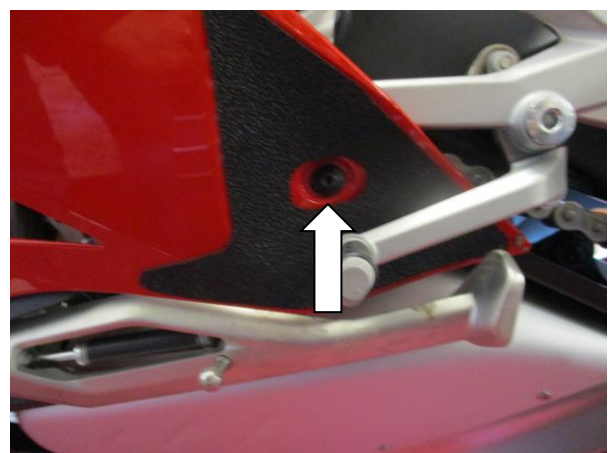

Picture 6

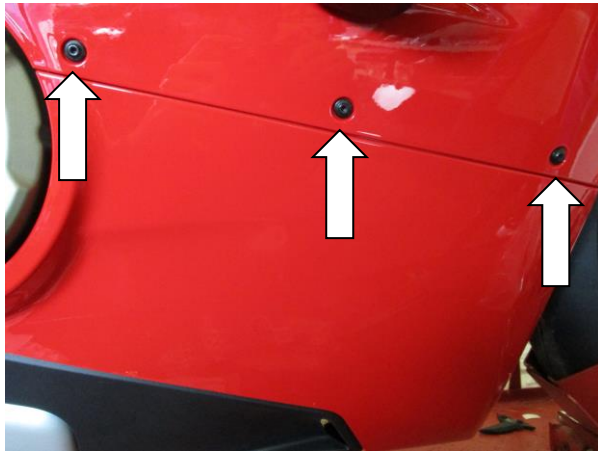

Picture 7



Picture 8

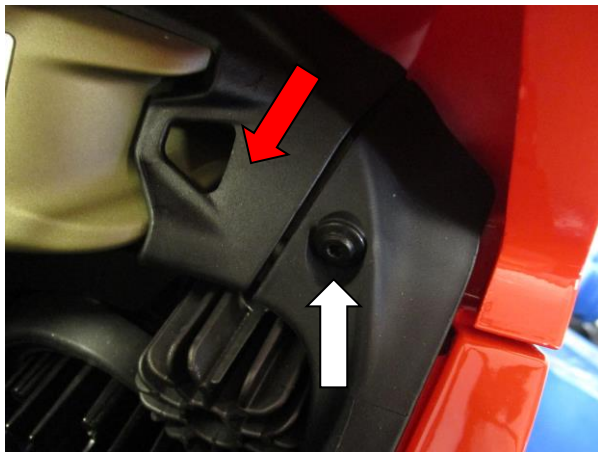

Picture 9



Picture 10

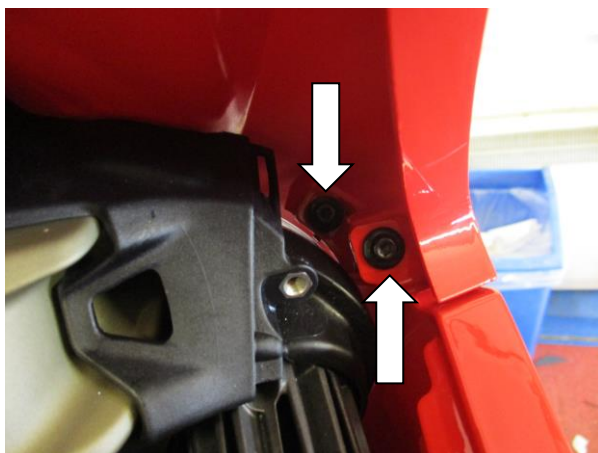

Picture 11

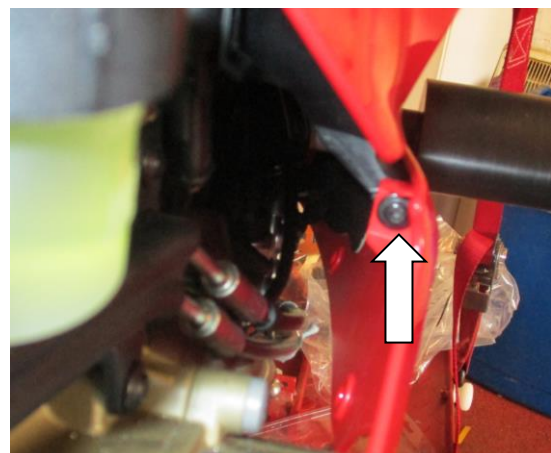

Picture 12



Picture 13



Picture 14

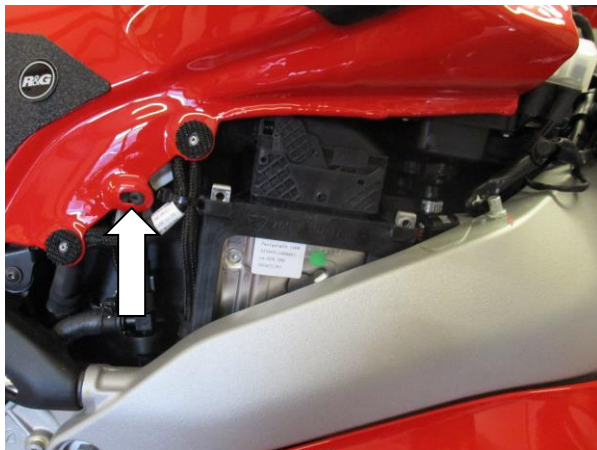

Picture 15

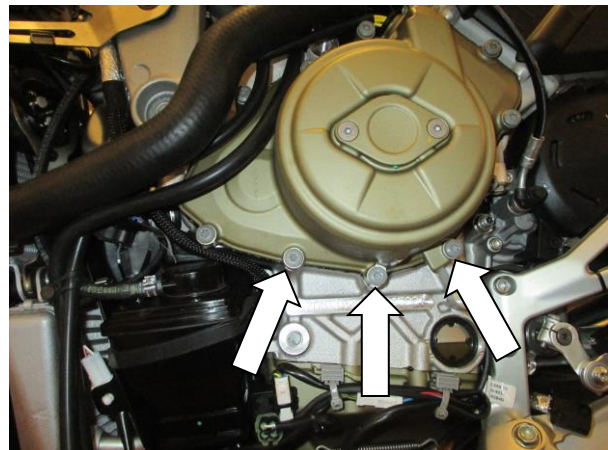

Picture 16

### **FITTING INSTRUCTIONS**

- Make sure the engine is cold before proceeding with the fitting of the R&G engine case slider.
- Remove the 2 tank cover panel bolts from both sides of the bike arrowed in **picture 1**. Pull the panel up gently until the locating pins release.
- Remove the bolt shown in **picture 2** from the bottom of the nose.
- Remove the bolts arrowed in **pictures 3 and 4** from underneath the lower fairings.
- Remove the radiator shroud bolt shown in **picture 5** from the left side.
- Remove the rear fairing bolt from the left side of the bike as shown in picture 6.
- Remove the 3 bolts holding the lower fairing to the upper fairing arrowed in **picture 7** from left side of the bike. The lower fairing can be removed at this stage by gently separating it from the radiator shroud.
- Remove the bolts shown in **pictures 8 and 9** from the left side.

R&G

Unit 1, Shelley's Lane, East Worldham, Alton, Hampshire, GU34 3AQ  
 Tel: +44 (0)1420 89007 Fax: +44 (0)1420 87301 [www.rg-racing.com](http://www.rg-racing.com) Email: [info@rg-racing.com](mailto:info@rg-racing.com)



- Slide the black inner fairing panel (previously secured with the bolts in pictures 8 and 9) forwards until the clips disengage. To release the clip at the front, pull the black cover marked with the red arrow in **picture 9** in the direction indicated by the arrow while simultaneously sliding the inner fairing panel forward.
- Remove the 2 bolts arrowed in **picture 11** from the left side.
- Remove the bolt arrowed in **picture 12** from the left side.
- Pull the main fairing away from the radiator shroud as shown in **picture 13** and away from the nose as shown in **picture 14**.
- Remove the main fairing, to do this pull gently on the edge of the fairing by the fuel tank to release the Velcro and plastic locator indicated in **picture 15**.
- To fit the R&G engine case slider remove the three M6 engine case bolts in the positions arrowed in **picture 16**.
- Offer up the R&G engine case slider (**item 1**) to the engine and secure in position using the three M6 bolts and washers (**items 2 and 3**) as shown in the top picture.
- Refit all fairings as original

ISSUE 2 27/05/2020 (NSY)

#### CONSUMER NOTICE

The catalogue description and any exhibition of samples are only broad indications of the Products and R&G may make design changes which do not diminish their performance or visual appeal and supplying them in such state shall conform to the order. The Buyer acknowledges no representation or warranty (other than as to title) has been given or will apply to the Products other than those in R&G's order or confirmation and the Buyer confirms it has chosen the Products as being of merchantable quality and suitable for its particular purposes. Where R&G fits the Products or undertakes other services it shall exercise reasonable skill and care and rectify any fault free of charge unless the workmanship has been disturbed. The Buyer is responsible for ensuring that the warranty on the motorcycle is not affected by the fitting of the Products. On return of any defective Products R&G shall at its option either supply a replacement or refund the purchase money but shall not be liable if the Products have been modified or used or maintained otherwise than in accordance with R&G's or manufacturer's instructions and good engineering practice or if the defect arises from accident or neglect. Other than identified above and subject to R&G not limiting its liability for causing death and personal injury, it shall not be liable for indirect or consequential loss and otherwise its liability shall be limited to the amounts paid by the Buyer for the Products or the fitting or service concerned. These terms do not affect the Buyer's statutory rights.

#### R&G RETURNS POLICY (NON-FAULTY GOODS)

Returns must be pre-authorized (if not pre-authorized the return will be rejected). Goods may only be returned direct to us if they were purchased direct from us (customer must prove if necessary). Otherwise to be returned to original vendor. Goods must be in re-sellable condition, in the opinion of R&G. All returns are subject to a 25% restocking and handling fee (25% of the gross value exc. P&P – at the prevailing price at time of purchase). The customer must pay any and all carriage charges. No returns of discontinued products, unless within 14 days of purchase. This policy does not affect your statutory rights and does not refer to faulty goods.

R&G

Unit 1, Shelley's Lane, East Worldham, Alton, Hampshire, GU34 3AQ  
Tel: +44 (0)1420 89007 Fax: +44 (0)1420 87301 [www.rg-racing.com](http://www.rg-racing.com) Email: [info@rg-racing.com](mailto:info@rg-racing.com)



**NOTICE DE MONTAGE POUR ECS0148**  
**PROTECTION CARTER MOTEUR**  
**POUR DUCATI V4 2018-**



**CE KIT CONTIENT LES ARTICLES ILLUSTRÉS ET ÉTIQUETÉS SUR LA PAGE.**

CERTAINES PARTIES PEUVENT ÊTRE PRÉSENTES UNIQUEMENT POUR LA CLARTÉ DES  
INSTRUCTIONS.

NE PAS PROCÉDER AU MONTAGE TANT QUE VOUS N'ÊTES PAS SÛR QUE TOUTES LES PIÈCES  
SOIENT PRÉSENTES.

**VEUILLEZ LIRE TOUTES LES INSTRUCTIONS AVANT DE CONTINUER.**  
**EN CAS DE DOUTE LORS DU MONTAGE DE NOS PRODUITS, CONSULTEZ**  
**UN DE NOS REVENDEURS OU FAITES APPEL À UN TECHNICIEN**  
**QUALIFIÉ.**

VEUILLEZ NOTER QUE LA FAÇON DONT LE KIT EST EMBALLÉ NE REPRÉSENTE PAS  
NECESSAIREMENT LA MANIÈRE DE LE MONTER SUR LA MOTO.

SI DES RONDELLES EN CAOUTCHOUC SONT UTILISÉES POUR MAINTENIR LES COMPOSANTS  
SUR LES BOULONS, ELLES PEUVENT ÊTRE JETÉES.

**NOTICE DISPONIBLE AU TÉLÉCHARGEMENT SUR : [WWW.RG-RACING.COM](http://WWW.RG-RACING.COM)**



<b><u>OUTILS REQUIS</u></b>	<b><u>VALEURS DE SERRAGE RECOMMANDÉES</u></b>
<ul style="list-style-type: none"> <li>• Clés Allen.</li> <li>• Clés Torx.</li> </ul>	M4 BOULON = 8Nm M5 BOULON = 12Nm M6 BOULON = 15Nm M8 BOULON = 20Nm M10 BOULON = 40Nm M12 BOULON = 40Nm

<b>ARTICLE NO.</b>	<b>DESCRIPTION</b>	<b>QTÉ</b>
ARTICLE 1	PROTECTION CARTER MOTEUR (ECS0148)	1
ARTICLE 2	M6 x 40mm BOULONS	3
ARTICLE 3	M6 RONDELLES	3

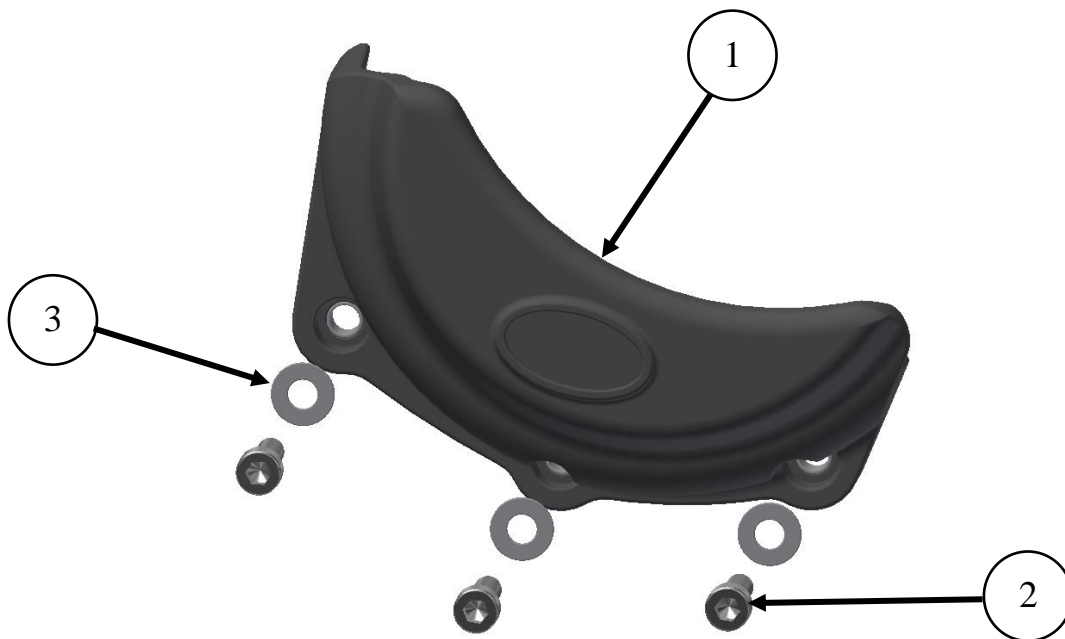

### **Schéma d'assemblage**





## **NOTICE DE MONTAGE**

- Veuillez-vous assurer que le moteur soit froid avant de procéder au montage de la protection carter moteur R&G.
- Retirez les 2 boulons du panneau du couvercle de réservoir des deux côtés de la moto fléchés sur la photo 1. Tirez doucement le panneau vers le haut jusqu'à ce que les goupilles de positionnement se libèrent.
- Retirez le boulon illustré sur la photo 2 au bas du nez.
- Retirez les boulons fléchés sur les photos 3 et 4 du dessous des carénages inférieurs.
- Retirez le boulon du carénage du radiateur illustré sur la photo 5 du côté gauche.
- Retirez le boulon de carénage arrière du côté gauche de la moto comme indiqué sur la photo 6.
- Retirez les 3 boulons qui fixent le carénage inférieur au carénage supérieur fléché sur la photo 7 du côté gauche de la moto. Le carénage inférieur peut être retiré à ce stade en le séparant doucement du carénage du radiateur.
- Retirez les boulons montrés sur les photos 8 et 9 du côté gauche.
- Faites glisser le panneau de carénage intérieur noir (précédemment fixé avec les boulons des photos 8 et 9) vers l'avant jusqu'à ce que les clips se désengagent. Pour libérer le clip à l'avant, tirez le couvercle noir marqué de la flèche rouge sur la photo 9 dans le sens indiqué par la flèche tout en faisant coulisser simultanément le panneau de carénage intérieur vers l'avant.
- Retirez les 2 boulons fléchés sur la photo 11 du côté gauche.
- Retirez le boulon fléché sur la photo 12 du côté gauche.
- Tirez le carénage principal loin du carénage du radiateur comme indiqué sur la photo 13 et loin du nez comme indiqué sur la photo 14.
- Retirez le carénage principal, pour ce faire tirez doucement sur le bord du carénage par le réservoir de carburant pour libérer le Velcro et le localisateur en plastique indiqué sur la photo 15.
- Pour monter la protection carter moteur R&G, retirez les trois boulons du carter moteur M6 dans les positions indiquées sur la photo 16.
- Présentez la protection carter moteur R&G (article 1) sur le moteur et fixez-la en position à l'aide des trois boulons et rondelles M6 (articles 2 et 3) comme indiqué sur la photo du haut.
- Remontez tous les carénages comme d'origine.

ISSUE 2 27/05/2020 (NSY)