



FITTING INSTRUCTIONS FOR CG0026
CHAIN GUARD



THIS KIT CONTAINS THE ITEMS PICTURED AND LABELLED OVER PAGE.

SOME PARTS MAY BE SHOWN FOR CLARITY OF INSTRUCTIONS ONLY.

DO NOT PROCEED UNTIL YOU ARE SURE ALL PARTS ARE PRESENT.

PLEASE READ ALL INSTRUCTIONS BEFORE PROCEEDING.

**IF IN ANY DOUBT WHEN FITTING OUR PRODUCTS, CONSULT ONE OF OUR DEALERS
OR HAVE FITTED BY A QUALIFIED TECHNICIAN.**

PLEASE NOTE THAT THE WAY THE KIT IS PACKED DOES NOT NECESSARILY REPRESENT THE WAY OF
MOUNTING TO THE BIKE.

IN THE EVENT OF RUBBER WASHERS BEING USED TO HOLD COMPONENTS ONTO BOLTS,
THESE RUBBER WASHERS CAN BE THROWN AWAY.

DIGITAL COPIES OF THESE INSTRUCTIONS ARE AVAILABLE FROM:

WWW.RG-RACING.COM

R&G Racing
Unit 1, Shelley's Lane, East Worldham, Alton, Hampshire, GU34 3AQ
Tel: +44 (0)1420 89007 Fax: +44 (0)1420 87301 www.rg-racing.com Email: info@rg-racing.com



<u>TOOLS REQUIRED</u>	<u>GENERAL TORQUE SETTINGS</u>
<ul style="list-style-type: none"> • 3mm, 4mm & 5mm A/F ALLEN TOOLS • 10mm A/F SPANNER 	<p>M4 BOLT = 8Nm</p> <p>M5 BOLT = 12Nm</p> <p>M6 BOLT = 15Nm</p> <p>M8 BOLT = 20Nm</p> <p>M10 BOLT = 40Nm</p> <p>M12 BOLT = 40Nm</p>

LEGEND

ITEM NO.	DESCRIPTION	QTY
ITEM 1	SMW0216 - 3mm ALUMINIUM BLACK CHAIN GUARD	1
ITEM 2	SMW0217 - 1.5mm BRUSHED STAINLESS COVER PLATE	1
ITEM 3	S0456 - FORWARD MOUNT SPACER	1
ITEM 4	M6x12mm - HEX HEAD BOLT	2
ITEM 5	M5x6mm - BUTTON HEAD BOLT	2
ITEM 6	M5x10mm - FLAT WASHER	2
ITEM 7	M6x12mm - FLAT WASHER	2

EXPLODED ASSEMBLY VIEW

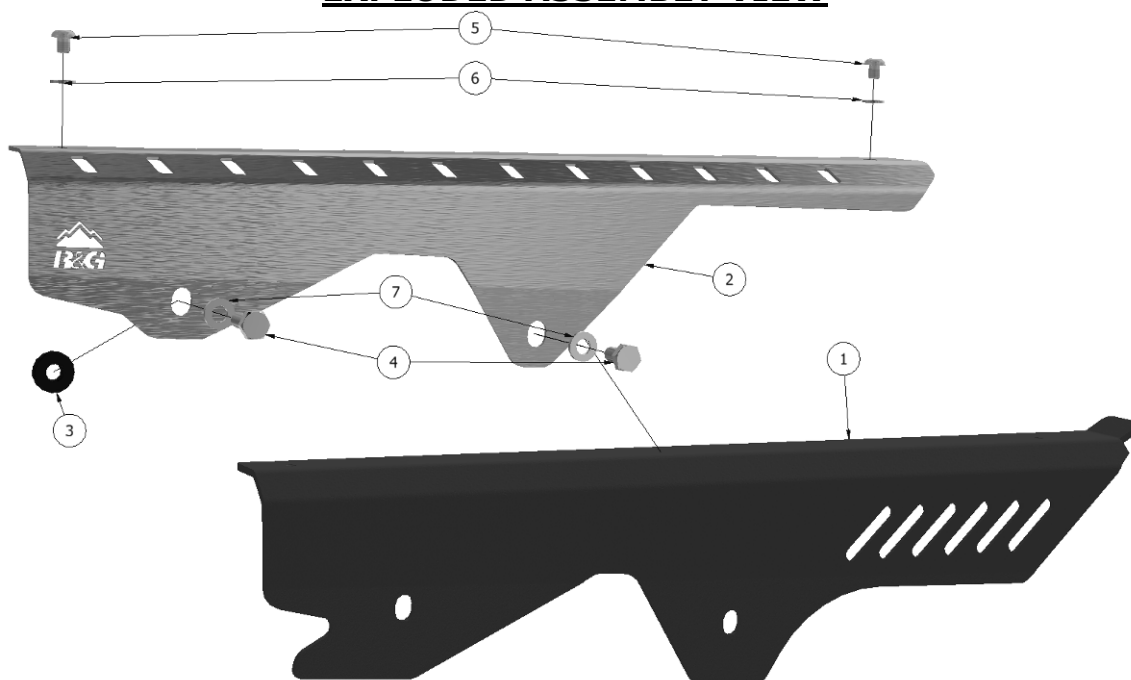



FITTING PICTURES

Picture 1



Picture 2



Picture 3

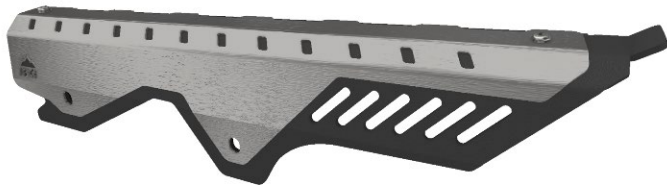

Picture 4



FITTING INSTRUCTIONS

- 1) Remove the plastic OEM chain guard by removing the two bolts shown in **Picture 1**.
- 2) Assemble the chain guard as shown in **Picture 2** by placing the stainless steel cover plate over the black aluminium chain guard.
 - a) Then place the M5 washers (**Item 6**) over the M5x6mm button head bolts (**Item 5**) and thread through the steel cover plate and into the aluminium chain guard.
 - b) The assembly should now resemble **Picture 3**.
- 3) Place the M6 washers (**Item 7**) over the M6 hex head bolts (**Item 4**) and apply a small amount of thread locking compound to the bolt threads.
 - a) Offer up the chain guard assembly to the motorcycle and thread in the M6 bolts.
 - b) Check the distance between the chain guard and the tyre, if wider/off road tyres are fitted the 3mm spacer may need to be fitted to increase the distance between the edge of tyre and the chain guard.

Please note: Remember to check the torque setting and distance to the tyre/chain regularly, when performing routine maintenance (cleaning chain/servicing).

See more R&G products for your Motorcycle in the link below:

[R&G Racing | All Products for Kawasaki - KLR 650 \(2022\) \(rg-racing.com\)](http://www.rg-racing.com)

ISSUE 1 - 03/01/2023 (TB)



CONSUMER NOTICE

The catalogue description and any exhibition of samples are only broad indications of the Products and R&G may make design changes which do not diminish their performance or visual appeal and supplying them in such state shall conform to the order. The Buyer acknowledges no representation or warranty (other than as to title) has been given or will apply to the Products other than those in R&G's order or confirmation and the Buyer confirms it has chosen the Products as being of merchantable quality and suitable for its particular purposes. Where R&G fits the Products or undertakes other services it shall exercise reasonable skill and care and rectify any fault free of charge unless the workmanship has been disturbed. The Buyer is responsible for ensuring that the warranty on the motorcycle is not affected by the fitting of the Products. On return of any defective Products R&G shall at its option either supply a replacement or refund the purchase money but shall not be liable if the Products have been modified or used or maintained otherwise than in accordance with R&G's or manufacturer's instructions and good engineering practice or if the defect arises from accident or neglect. Other than identified above and subject to R&G not limiting its liability for causing death and personal injury, it shall not be liable for indirect or consequential loss and otherwise its liability shall be limited to the amounts paid by the Buyer for the Products or the fitting or service concerned. These terms do not affect the Buyer's statutory rights.

R&G RACING RETURNS POLICY (NON-FAULTY GOODS)

Returns must be pre-authorized (if not pre-authorized the return will be rejected). Goods may only be returned direct to us if they were purchased direct from us (customer must prove if necessary). Otherwise to be returned to original vendor. Goods must be in re-sellable condition, in the opinion of R&G Racing. All returns are subject to a 25% restocking and handling fee (25% of the gross value exc. P&P – at the prevailing price at time of purchase). The customer must pay any and all carriage charges. No returns of discontinued products, unless within 14 days of purchase. This policy does not affect your statutory rights and does not refer to faulty goods.⁴

R&G Racing

Unit 1, Shelley's Lane, East Worldham, Alton, Hampshire, GU34 3AQ

Tel: +44 (0)1420 89007 Fax: +44 (0)1420 87301 www.rg-racing.com Email: info@rg-racing.com



NOTICE DE MONTAGE POUR CG0026
PROTECTION CHAÎNE



CE KIT CONTIENT LES ARTICLES ILLUSTRÉS ET ÉTIQUETÉS SUR LA PAGE.

CERTAINES PIÈCES PEUVENT ÊTRE INDIQUÉES UNIQUEMENT POUR LA CLARTÉ DES INSTRUCTIONS.

NE PAS CONTINUER AVANT D'ÊTRE SÛR DE LA PRÉSENCE DE TOUTES LES PIÈCES.

VEUILLEZ LIRE TOUTES LES INSTRUCTIONS AVANT DE CONTINUER.

**EN CAS DE DOUTE LORS DE L'INSTALLATION DE NOS PRODUITS, CONSULTEZ UN DE NOS REVENEURS
OU FAITES INSTALLER PAR UN TECHNICIEN QUALIFIÉ**

VEUILLEZ NOTER QUE LA FAÇON DONT LE KIT EST EMBALLÉ NE REPRÉSENTE PAS NÉCESSAIREMENT LE
MODE DE MONTAGE SUR LE VÉLO.

EN CAS D'UTILISATION DE RONDELLES EN CAOUTCHOUC POUR MAINTENIR LES COMPOSANTS SUR LES
BOULONS, CES RONDELLES EN CAOUTCHOUC PEUVENT ÊTRE JETÉES.

NOTICE DE MONTAGE DISPONIBLE AU TÉLÉCHARGEMENT SUR :

WWW.RG-RACING.COM

R&G Racing

Unit 1, Shelley's Lane, East Worldham, Alton, Hampshire, GU34 3AQ

Tel: +44 (0)1420 89007 Fax: +44 (0)1420 87301 www.rg-racing.com Email: info@rg-racing.com



<u>OUTILS REQUIS</u>	<u>VALEURS DE SERRAGE</u>
<ul style="list-style-type: none"> • CLÉS ALLEN 3mm, 4mm & 5mm • CLÉ À MOLETTE 10mm 	BOULON M4 = 8Nm BOULON M5 = 12Nm BOULON M6 = 15Nm BOULON M8 = 20Nm BOULON M10 = 40Nm BOULON M12 = 40Nm

LÉGENDE

ARTICLE NO.	DESCRIPTION	QTÉ
ARTICLE 1	SMW0216 - 3mm PROTECTION CHAINE NOIR EN ALUMINIUM	1
ARTICLE 2	SMW0217 - 1.5mm PLAQUE DE RECOUVREMENT EN ACIER INOXYDABLE BROSSÉ	1
ARTICLE 3	S0456 - ENTRETOISE DE MONTAGE AVANT	1
ARTICLE 4	M6x12mm - BOULON	2
ARTICLE 5	M5x6mm - BOULON	2
ARTICLE 6	M5x10mm - RONDELLE PLATE	2
ARTICLE 7	M6x12mm - RONDELLE PLATE	2

SHÉMA D'ENSEMBLE

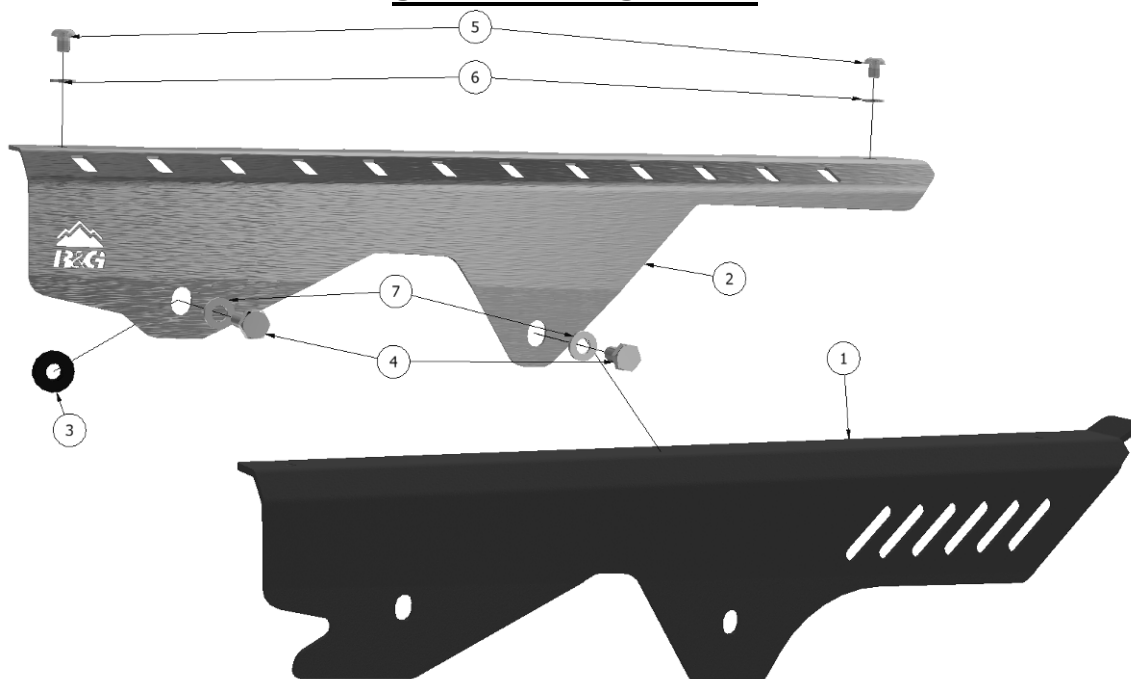

R&G Racing

Unit 1, Shelley's Lane, East Worldham, Alton, Hampshire, GU34 3AQ

Tel: +44 (0)1420 89007 Fax: +44 (0)1420 87301 www.rg-racing.com Email: info@rg-racing.com



PHOTOS DE MONTAGE

Photo 1

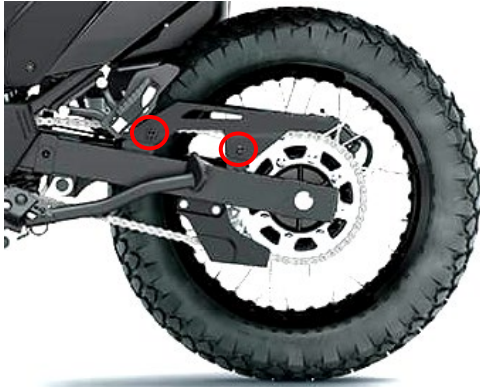

Photo 2



Photo 3

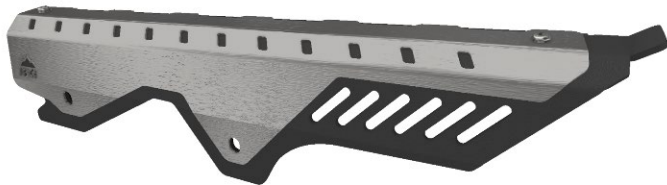

Photo 4



NOTICE DE MONTAGE

Retirez le protège-chaîne d'origine en plastique en retirant les deux boulons illustrés sur la photo 1.

4) Assemblez le protège-chaîne comme indiqué sur la photo 2 en plaçant la plaque de recouvrement en acier inoxydable sur le protège-chaîne en aluminium noir.

a) Placez ensuite les rondelles M5 (article 6) sur les boulons à tête ronde M5x6 mm (article 5) et vissez-les à travers la plaque de recouvrement en acier et dans le protège-chaîne en aluminium.

b) L'assemblage devrait maintenant ressembler à la Photo 3.

5) Placez les rondelles M6 (article 7) sur les boulons à tête hexagonale M6 (article 4) et appliquez une petite quantité de frein filet sur les filets des boulons.

a) Présentez l'ensemble du protège-chaîne sur la moto et vissez les boulons M6.

b) Vérifiez la distance entre le protège-chaîne et le pneu, si des pneus plus larges/hors route sont montés, l'entretoise de 3mm peut être nécessaire pour augmenter la distance entre le bord du pneu et le protège-chaîne.

Attention : N'oubliez pas de vérifier régulièrement le couple de serrage et la distance par rapport au pneu/chaîne lors de l'entretien de routine (nettoyage de la chaîne/entretien).

Voir plus de produits R&G pour votre moto via ce lien :

[R&G Racing | All Products for Kawasaki - KLR 650 \(2022\) \(rg-racing.com\)](http://www.rg-racing.com)

ISSUE 1 - 03/01/2023 (TB)

R&G Racing

Unit 1, Shelley's Lane, East Worldham, Alton, Hampshire, GU34 3AQ

Tel: +44 (0)1420 89007 Fax: +44 (0)1420 87301 www.rg-racing.com Email: info@rg-racing.com

**CONSUMER NOTICE**

The catalogue description and any exhibition of samples are only broad indications of the Products and R&G may make design changes which do not diminish their performance or visual appeal and supplying them in such state shall conform to the order. The Buyer acknowledges no representation or warranty (other than as to title) has been given or will apply to the Products other than those in R&G's order or confirmation and the Buyer confirms it has chosen the Products as being of merchantable quality and suitable for its particular purposes. Where R&G fits the Products or undertakes other services it shall exercise reasonable skill and care and rectify any fault free of charge unless the workmanship has been disturbed. The Buyer is responsible for ensuring that the warranty on the motorcycle is not affected by the fitting of the Products. On return of any defective Products R&G shall at its option either supply a replacement or refund the purchase money but shall not be liable if the Products have been modified or used or maintained otherwise than in accordance with R&G's or manufacturer's instructions and good engineering practice or if the defect arises from accident or neglect. Other than identified above and subject to R&G not limiting its liability for causing death and personal injury, it shall not be liable for indirect or consequential loss and otherwise its liability shall be limited to the amounts paid by the Buyer for the Products or the fitting or service concerned. These terms do not affect the Buyer's statutory rights.

R&G RACING RETURNS POLICY (NON-FAULTY GOODS)

Returns must be pre-authorized (if not pre-authorized the return will be rejected). Goods may only be returned direct to us if they were purchased direct from us (customer must prove if necessary). Otherwise to be returned to original vendor. Goods must be in re-sellable condition, in the opinion of R&G Racing. All returns are subject to a 25% restocking and handling fee (25% of the gross value exc. P&P – at the prevailing price at time of purchase). The customer must pay any and all carriage charges. No returns of discontinued products, unless within 14 days of purchase. This policy does not affect your statutory rights and does not refer to faulty goods.⁴

R&G Racing

Unit 1, Shelley's Lane, East Worldham, Alton, Hampshire, GU34 3AQ

Tel: +44 (0)1420 89007 Fax: +44 (0)1420 87301 www.rg-racing.com Email: info@rg-racing.com